

SIMPLY SWITCH TO LED ... NOW!

THE RIGHT LED SOLUTIONS –
BASED ON LAMPS OR LUMINAIRES

JUNE 2024



LEDVANCE.COM



LEDVANCE



THE BEST TIME TO CHANGE IS NOW! PLAY IT SAFE WITH EU- COMPLIANT LED SOLUTIONS

The ban on mercury-containing and inefficient lamps has been in force since 2023. With high energy costs and increasing demand for sustainable lighting, now is the best time to move over to EU-compliant, energy-efficient and cost-effective LED lighting.

LEDVANCE offers an alternative for every need with a comprehensive range of luminaires, intelligent lighting products and advanced LED lamps. The solutions with LED lamps are simple and economically attractive as the luminaire can be retained. Switching to LED luminaires can also optimize light output and quality, which can also significantly increase productivity.



BEST PLANS, BEST LIGHT OUR SERVICE OFFERING FOR YOUR PERFECT PROJECT MANAGEMENT

Every successful project starts with a good plan. So why not benefit from our tailor-made advice for planning your lighting project smoothly and successfully?

We take care of the whole process and offer you individual solutions for your wishes. Your options at a glance.

Are you interested in our services for your projects?
Our experts are happy to advise you. You can reach us at:
contact@ledvance.com
+49 89 780673-600

4 OPTIONS FOR ALL SITUATIONS – HOW TO SWITCH

SOLUTIONS WITH LED LAMPS



RETROFIT



Switching from fluorescent lamps to LED lamps in existing luminaires is quick, easy and economical – either as retrofits or conversions.

Simple 1:1 replacement:

- Wide range of LED tubes and DULUX LED for easy, quick and safe lamp replacement
- No rewiring necessary
- The most cost effective LED alternative for installations with CCG or compatible ECG
- Find the right LED tube for your existing ballast in just a few steps with the Tube Finder

Rewiring or modification:

- If there is no retrofit alternative or if the customer values maximum energy savings and low maintenance
- Wide range of LED tubes and DULUX LED for operation directly on AC mains
 - Optional matching conversion kits for LED tubes for easy rewiring
 - LED TUBE EXTERNAL SYSTEM when a dimmable LED tube or emergency lighting solution is needed



Go directly to the Tube Finder: ledvance.com/tubefinder

SOLUTIONS WITH LED LUMINAIRES



UPGRADE



If the focus is on optimal light output and quality, maximum efficiency and perhaps added benefits, it's worth upgrading the luminaires or installing new ones.

Upgrade using LED upgrade kits:

- If an existing luminaire needs to be kept but electric or mechanical interfaces are too old for a retrofit or conversion
- LED upgrade kits that replace entire components of the original luminaire

NEW INSTALLATION



Complete replacement with modern LED luminaires:

- If the existing housing or other components have reached the end of their life
- If lighting performance requirements have changed (e. g. light distribution or quality)
- If a light management system needs to be integrated, or there's an upgrade to human centric lighting
- If aesthetical or functional design requirements have changed



THE LAMP FINDER – HERE'S HOW IT WORKS:

The Lamp Finder gives you the answers you need. Just enter some information about your traditional lamp and we will give you alternative LED solutions for your installation. If there is no suitable LED lamp you can find alternative LED luminaires in our online product catalog.

- ▶ Provide some details of your traditional lamp such as wattage, light color and control gear and you will get possible LED alternatives.



Check it out: ledvance.com/lampfinder

CLEAR ORIENTATION: CONVERSION TO LED LAMPS WITHOUT NEW CE MARKING

There is clarity at last when it comes to converting existing luminaires to LED technology. In a new white paper, the Central Association of the Electrical Engineering and Electronics Industry (ZVEI) defines clear criteria, according to which the existing CE marking remains valid when modernizing luminaires to LED technology.



A PERFECT SOLUTION

The basis is the **EU Blue Guide (2022)** and its definition of “significant changes of products”. If **no significant changes are made to the performance, application or construction** when converting an existing luminaire with old lighting technology to LED technology, no new product will be created. The electrician making the conversion will therefore not become a manufacturer and a new CE declaration of conformity will not be required. Along with the 1:1 retrofit solution, this makes it very easy to convert existing luminaires to efficient LED lamps cost-effectively.

KEEP THE HOUSING

Following the lamp ban in 2023, most of the industry has recommended either a simple 1:1 retrofit solution (if technically possible) or a completely new LED luminaire when switching to LED technology. But there are other options for keeping existing lighting solutions and any associated components such as light management systems or ventilation systems in operation and reducing electrical waste: conversion to LED lamps or complete LED upgrade kits that replace entire components of the original luminaire. The ZVEI white paper says that both solutions are possible without a new CE declaration of conformity.

Read all the details here: www.zvei.org

The ZVEI provides guidance: if no significant changes are made in line with the EU Blue Guide (2022), it is not a new product and the person converting the product will not become a manufacturer.

CLEAR RULES, USEFUL SOLUTIONS

CONVERSIONS MADE EASY

The guidelines from the white paper will make it even easier for you to convert to efficient LED lamps cost-effectively. LEDVANCE offers a comprehensive portfolio of solutions to help you make the switch and is always available to answer any questions you may have.



STEP 1: SUITABILITY OF THE EXISTING LUMINAIRE

To convert an existing luminaire or lighting system to LED lamps, it is necessary to assess the condition of the luminaire to determine whether existing housings and components are suitable.

STEP 2: RISK ASSESSMENT

If during rewiring of the LED luminaire no significant changes are made to the performance, application or construction, the existing CE marking of the luminaire remains valid and a new CE declaration of conformity is not required.

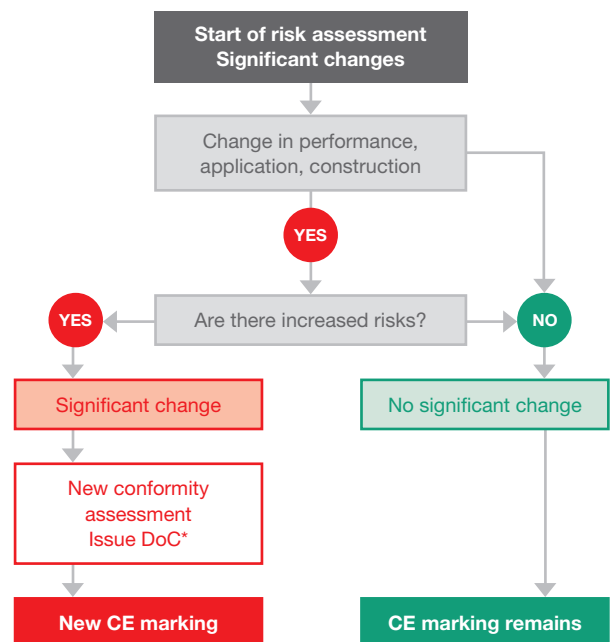

*Declaration of Conformity

RETROFIT OR CONVERSION: WHICH PROCESS IS THE RIGHT ONE?

RETROFIT

ADVANTAGES

- Easiest installation
- Lowest installation costs

DISADVANTAGES

- Compatibility check required for ECG¹

CONVERSION

ADVANTAGES

- No compatibility check
- Maximum efficiency and no ballast maintenance

DISADVANTAGES

- Higher installation costs
- More complex installation and additional material required

¹Check ECG compatibility at ledvance.com/compatibility or ledvance.com/tubefinder

INSTALLATION INSTRUCTIONS

REPLACEMENT MADE EASY

RETROFIT IN T8 LUMINAIRE WITH CCG

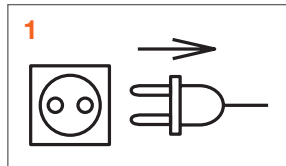

1
Disconnect luminaire from mains

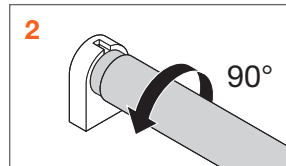

2
Unscrew and remove conventional T8 lamp

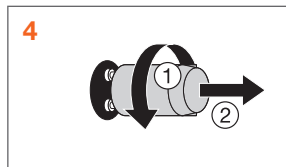
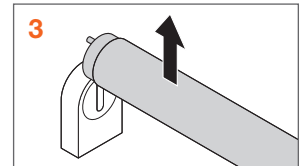

4
Remove conventional starter

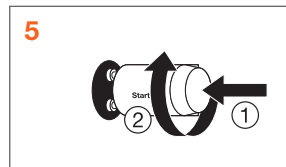

5
Replace with LED TUBE starter supplied in the EM/UNIVERSAL package.

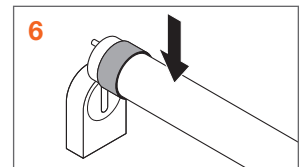

6
Insert LED TUBE T8 EM/UNIVERSAL

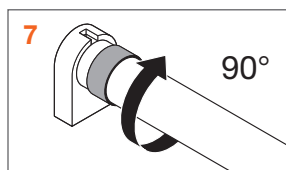

7
Screw in LED TUBE T8 EM/UNIVERSAL

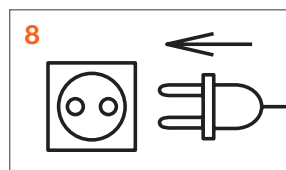

8
Turn on power

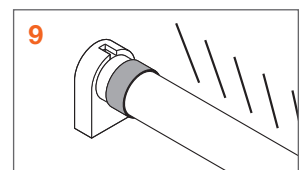

9
That's it!

RETROFIT IN T8 OR T5 LUMINAIRE WITH ECG

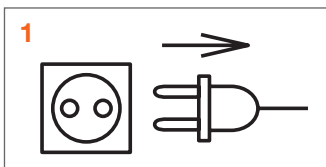

1
Disconnect luminaire from the mains

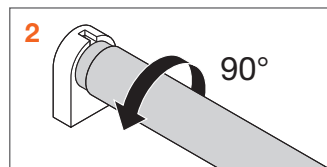

2
Unscrew and remove conventional T8 or T5 lamp

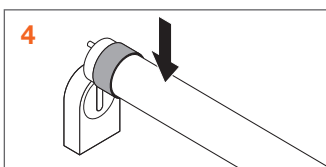
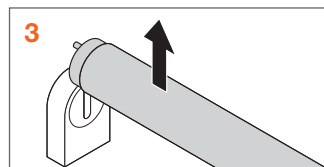

4
Insert and screw in LED TUBE T8 HF/UNIVERSAL or T5 HF

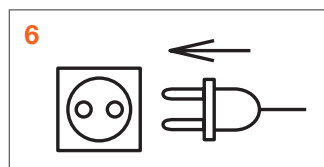
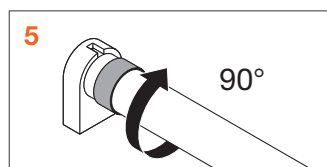

6
Turn on power

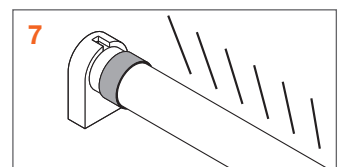

7
That's it!

Check ECG compatibility at ledvance.com/compatibility or www.ledvance.com/tubefinder



CONVERSION OF T8 OR T5 LUMINAIRES

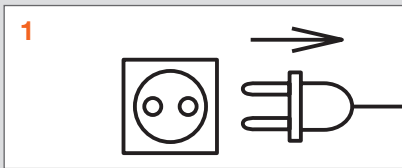

1 Disconnect luminaire from mains

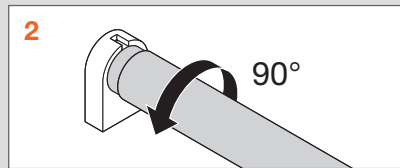

2 Unscrew and remove conventional T8 or T5 lamp

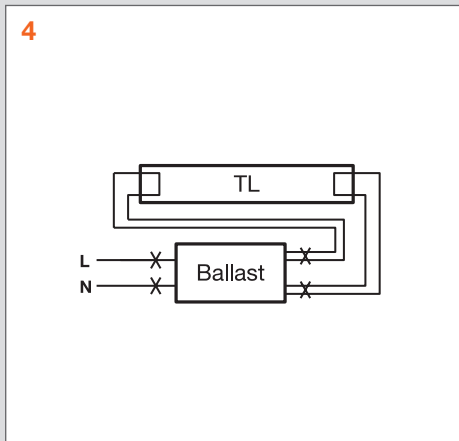
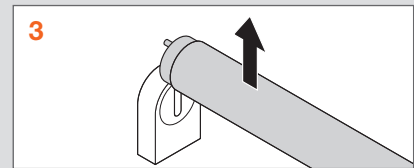

4 Remove ECG/CCG from the luminaire
For CCG: also remove capacitors for reactive power compensation

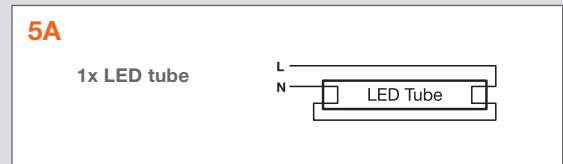

5A Rewiring following wiring diagram for single-lamp luminaires

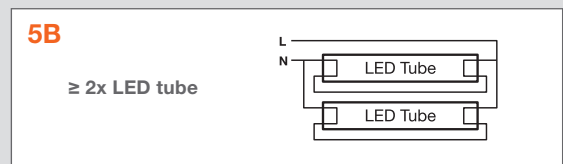

5B Rewiring following wiring diagram for multi-lamp luminaires

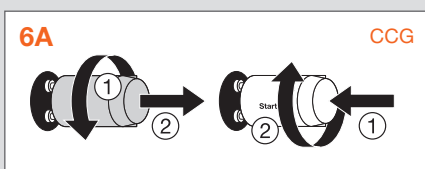

6A Replace conventional starter with LED TUBE starter supplied in the T8 EM/UNIVERSAL package

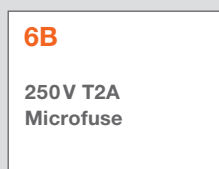

6B Insert microfuse (250 V, T2A)

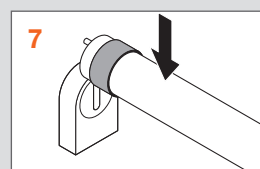

7 Insert and screw in LED TUBE T8 or T5

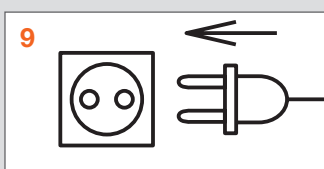
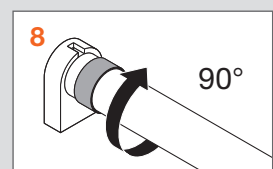

9 Turn on power

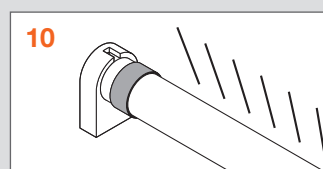

10 That's it!

IMPORTANT!

CE mark of the luminaire remains valid.* Further information:
www.zvei.org



NOTES

- The rewiring may only be carried out by qualified electricians.
- After rewiring, fluorescent lamps may no longer be used in the luminaire, only LED tubes. This should be mentioned on the luminaire's new type plate, for example. The LEDVANCE LED tubes are already provided with an appropriate sticker.
- * According to the ZVEI White Paper: if no significant changes are made to the performance, application or construction when converting an existing luminaire, the existing CE mark of the luminaire remains valid and a new CE declaration of conformity will not be required. Further information: www.zvei.org

LED TUBES 4 SOLUTIONS FOR ALL SITUATIONS

SOLUTIONS WITH LED TUBES



RETROFIT



Switching from fluorescent tubes to LED tubes in existing luminaires is quick, easy and economical – either as retrofits or conversions.

Simple 1:1 replacement

- The most cost effective LED alternative for installations with CCG or compatible ECG
- Wide range of LED tubes for easy, quick and safe lamp replacement

CONVERSION



Rewiring or modification

- If there is no retrofit alternative or if the customer values maximum energy savings and low maintenance
- Wide range of LED tubes for operation directly on AC mains
- Optional matching conversion kits for easy rewiring
- LED TUBE EXTERNAL SYSTEM when a dimmable LED tube or emergency lighting solution is needed

SOLUTIONS WITH LED LUMINAIRES



UPGRADE



If the focus is on optimal light output and quality, maximum efficiency and perhaps added benefits, it's worth upgrading the luminaires or installing new ones.

Upgrade luminaire

- If an existing luminaire needs to be kept but electric or mechanical interfaces are too old for a retrofit or conversion

NEW INSTALLATION



New luminaire

- If the existing housing or other components have reached the end of their life
- If lighting performance requirements have changed (e.g. light distribution or quality)
- If a light management system needs to be integrated, or there's an upgrade to human centric lighting
- If aesthetic or functional design requirements have changed

RETROFIT

CONVERSION

LED T8 EM
LED T8 UNIVERSAL

LED T8 HF
LED T5 HF

LED T5 AC MAINS

LED TUBE EXTERNAL SYSTEM:
LED TUBE T8/T5 EXTERNAL
LED DRIVER EXTERNAL



NOT SURE WHAT TO CHOOSE?

LEDVANCE takes care of tailor-made calculations and offers you a customized solution for your lighting requirements – all from a single source. Please get in touch.

Email: contact@ledvance.com
Phone: +49 89 780673-660

LEDVANCE TRAINING CENTER: DEEPER KNOWLEDGE MADE EASY

Learn all you need to know about Lamp Ban 2023, products and applications. And discover the world of light in an interactive and interesting way.

Simply register at training.ledvance.com

LED TUBE APPLICATION MATRIX

LEDVANCE LED TUBE PORTFOLIO	T8							T5	T9C	T8/T5		
	ULTRA OUTPUT S	S	ULTRA OUTPUT P	P	ULTRA OUTPUT V	V	CONNECTED P	FOOD P	MOTION SENSOR P	HF/AC MAINS	T9 C	LED TUBE EXTERNAL SYSTEM
 <p>INDUSTRY Typical operating time: 24 h/day 6 days/week Recommended illuminance: 200–500+ lux</p>	✓	✓	✓	✓						✓		✓
 <p>WAREHOUSE Typical operating time: 24 h/day 6 days/week Recommended illuminance: 200–300 lux</p>	✓	✓	✓	✓	✓	✓	✓		✓ ¹	✓		✓
 <p>PARKING Typical operating time: 24 h/day 7 days/week Recommended illuminance: 75–300 lux</p>			✓	✓	✓	✓	✓		✓ ¹	✓		✓
 <p>RETAIL Typical operating time: 15 h/day 7 days/week Recommended illuminance: 500+ lux</p>	✓	✓	✓	✓						✓		✓
 <p>FOOD PRESENTATION Typical operating time: 15 h/day 7 days/week Recommended illuminance: Special spectrum with high CRI-R9 level, shatter protection</p>							✓			✓		
 <p>OFFICE Typical operating time: 14 h/day 5 days/week Recommended lighting intensity: 500+ lux</p>	✓		✓							✓	✓	✓
 <p>RESIDENTIAL AREAS Typical operating time: 2.7 h/day 7 days/week Recommended illuminance: 100+ lux</p>					✓	✓			✓	✓	✓	
 <p>OUTDOOR AREAS/PUBLIC TRANSPORTATION Typical operating time: 10 h/day 7 days/week Recommended illuminance: 5–500+ lux</p>	✓	✓	✓	✓						✓	✓	✓
 <p>PUBLIC BUILDINGS/ SPORTS AND LEISURE Typical operating time: 15 h/day 7 days/week Recommended illuminance: 100–500+ lux</p>	✓	✓	✓	✓			✓			✓	✓	✓

¹ < 10 light outlets

THREE SEGMENTS FOR EVERY NEED

PERFORMANCE & TECHNOLOGY

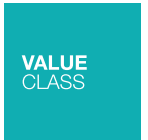

LED TUBE T8 EM ULTRA OUTPUT S
Operation on CCG and AC mains

LED TUBE T8 EM S
Operation on CCG and AC mains

- Luminous flux up to 4 100 lm
- Efficiency up to 185 lm/W
- Lifetime of 75 000 h¹
- 1 200 mm, 1 500 mm



LEDVANCE 5 year guarantee

CRI 80

GLASS

LED TUBE T8 EM ULTRA OUTPUT P
Operation on CCG and AC mains

LED TUBE T8 EM P
Operation on CCG and AC mains

- Luminous flux up to 3 700 lm
- Efficiency up to 160 lm/W
- Lifetime of 60 000 h¹
- 1 200 mm, 1 500 mm



LEDVANCE 5 year guarantee

CRI 80

GLASS

LED TUBE T8 EM ULTRA OUTPUT V
Operation on CCG and AC mains

LED TUBE T8 EM V
Operation on CCG and AC mains

- Luminous flux up to 3 500 lm
- Efficiency up to 120 lm/W
- Lifetime of 30 000 h¹
- 1 200 mm, 1 500 mm



LEDVANCE 3 year guarantee

CRI 80

GLASS

MAKE THE RIGHT CHOICE

CONTROL GEAR AND TECHNOLOGY OVERVIEW

COMPATIBILITY	CCG	ECG	AC MAINS
LED TUBE EM: "Electro magnetic" Replacement for T8 fluorescent lamps	✓	✗	✓
LED TUBE AC: "AC Mains" Replacement for T5 fluorescent lamps	✗	✗	✓

✗ = not compatible ✓ = compatible

¹L70/B50



The LEDVANCE LED TUBE LED tubes come in Superior Class, Performance Class and Value Class. This allows you to easily meet the requirements of each of your lighting projects. And when it comes to technology, the LEDVANCE LED TUBE range will also have the answer – no matter whether operated on ECG², CCG or AC mains.

LED TUBE T8 UNIVERSAL/HF ULTRA OUTPUT P
 HF on ECG² | UNIVERSAL on ECG², CCG and AC mains

LED TUBE T8 UNIVERSAL/HF P
 HF on ECG² | UNIVERSAL on ECG², CCG and AC mains

- Lumen output up to 3 700 lm
- Efficiency up to 161 lm/W
- Lifetime of UNIVERSAL: 60 000 h¹ /of HF: 75 000 h¹
- 1 200 mm, 1 500 mm



LEDVANCE
5 year guarantee

GLASS

CRI 80

- Lumen output up to 3 100 lm
- Efficiency up to 155 lm/W
- Lifetime of UNIVERSAL: 60 000 h¹ /of HF: 75 000 h¹
- 600 mm, 1 200 mm, 1 500 mm

LED TUBE T8 UNIVERSAL/HF V
 HF on ECG² | UNIVERSAL on ECG², CCG and AC mains

- Lumen output up to 2 800 lm
- Efficiency up to 116 lm/W
- Lifetime of 30 000 h¹
- UNIVERSAL: 600 mm, 1 200 mm, 1 500 mm
- HF: only 600 mm



LEDVANCE
3 year guarantee

GLASS

CRI 80



MAKE THE RIGHT CHOICE CONTROL GEAR AND TECHNOLOGY OVERVIEW

COMPATIBILITY	CCG	ECG ²	AC MAINS
LED TUBE HF: "High frequency" Replacement for T8/T5 fluorescent lamps	✗	✓	✗
LED TUBE UN: "Universal" One for everything. Replacement for T8 fluorescent lamps	✓	✓	✓

✗ = not compatible ✓ = compatible

¹L70/B50
²Check ECG compatibility at ledvance.com/compatibility or ledvance.com/tubefinder

LEDVANCE TUBES

SPECIAL TYPES, SPECIAL TASKS, SPECIAL SOLUTIONS



The LEDVANCE LED TUBE range also includes specialists. You can use them to offer your customers real added value for special applications.

LED TUBE T8 EM HIGH TEMPERATURE ULTRA OUTPUT
Operation on CCG and AC mains

For ambient temperatures of up to to +80 °C.

- For demanding applications with high ambient temperatures of up to to +80 °C
- Lifetime at 25 °C ambient temperature: up to 75 000h, lifetime at 80 °C ambient temperature: up to 17 500 h
- 2 year guarantee for operation between T_c 61 °C and T_c max., 5 year guarantee for operation at T_c ≤ 60 °C. Refer to www.ledvance.com/guarantee for precise conditions



LED TUBE T8 EM HIGHBAY ULTRA OUTPUT
Operation on CCG and AC mains

With a beam angle < 100° and significantly higher lux level than standard LED tubes.

- Higher illuminance level than standard LED tubes thanks to narrow beam angle of 90°
- Very long lifetime: up to 75 000 h¹



LED TUBE T8 EM ULTRA OUTPUT 6 KV
Operation on CCG and AC mains

High performance LED tubes for 6 kV surge protection.

- LED tube with very high surge protection of 6 kV for e.g. train stations
- Very long lifetime: up to 75 000 h¹



LED TUBE T8 EM CHIP CONTROL
Operation on CCG and AC mains

With special sleeve which filters light below 500 nm for demanding applications like semiconductor production.

- Replacement of trad. T8 CHIP CONTROL tubes
- PET sleeve minimizes light output below 500 nm
- For demanding applications in yellow rooms



¹ L70/B50

LED TUBE T8 EM ENERGY EFFICIENCY CLASS A S

Operation on CCG and AC mains

LED tube with maximum energy savings thanks to energy efficiency class A.

- Highest possible energy savings thanks to EEC A
- Extremely high efficiency of 210 lm/W
- Extremely long lifetime: up to 100 000 h¹

**LED TUBE T8 EM CONNECTED P**

Operation on CCG and AC mains

Light on demand: intelligent control via a sensor reduces energy consumption.

- Communication via Zigbee 3.0
- Glass tube with splinter protection
- Only in connection with the LEDVANCE Connected Sensor:
 - Installation height
 - Low bay: up to 4 m
 - High bay: 4–14 m

**LED TUBE T8 EM MOTION SENSOR P**

Operation on CCG and AC mains

With movement there's light. Lighting control via the microwave sensor integrated in the tube.

- Integrated 5.8 GHz microwave sensor
- Available in three lengths: 600 mm, 1 200 mm, 1 500 mm
- Detection range up to 5 m
- 2-step dimming: 100 % (5 min), then 20 % (2 min), then off
- Also works in closed luminaires

**LED TUBE T8 EM FOOD P**

Operation on CCG and AC mains

A burst of freshness for food presentation thanks to a high R9 value.

- Similar spectrum to traditional NATURA (76) lamps with a high R9 value
- Available in four lengths: 600 mm, 900 mm, 1 200 mm, 1 500 mm
- Luminous flux up to 1 700 lm
- Ideal for meat processing plants, butchers, supermarkets

**LED TUBE T9 EM V**

Operation on CCG and AC mains

A great all-rounder: the efficient LED alternative for traditional T9 fluorescent lamps.

- Retrofit solution without rewiring
- Suitable for many luminaires thanks to rotatable base
- Uniform illumination
- Lifetime of 30 000 h¹

¹L70/B50

LEDVANCE LED TUBE T5

LOWER MAINTENANCE COSTS, HIGHER LIGHT QUALITY



LED TUBE T5 are the right energy-efficient and SLR-compliant replacement for conventional T5 HO or T5 HE fluorescent tubes. Available as LED TUBE T5 HF for operation on ECG² or as LED TUBE T5 AC Mains for operation directly on mains voltage (AC). What's particularly convenient is that you can keep using existing luminaires.



THE BENEFITS OF BOTH PRODUCT SEGMENTS AT A GLANCE:

- Maximum luminous flux of up to 5 600 lm
- Low-flicker according to EU 2019/2020 (SVM ≤ 0.4; P_{st}LM ≤ 1)
- Shatter-proof glass tubes
- Lifetime of up to 50 000 h¹



LED TUBE T5 HF P Operation on ECG²

- High energy savings and longer lifetime result in fast payback times
- Quick and easy installation
- Operation on compatible ECG^{2,3}
- Shatter-proof glass tubes

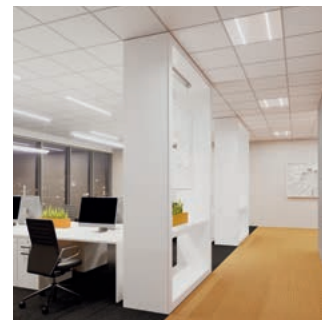

LED TUBE T5 AC MAINS P Operation on AC mains

- Rewired directly on AC mains
- Removes any compatibility issues and energy losses from the control gear
- Eliminating maintenance costs associated with ballast replacements
- Shatter-proof glass tube



¹ L70/B50 | ² Check ECG compatibility at ledvance.com/compatibility or ledvance.com/tubefinder
³ Non-compatible with a direct mains voltage connection, 220-240 V AC

WE'LL HELP YOU CHOOSE THE RIGHT LED TUBE

T5 LUMINAIRE WITH G5 BASE

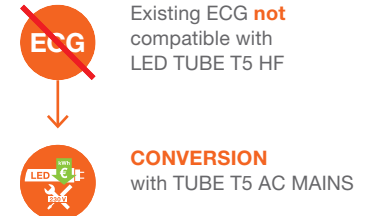

T8 LUMINAIRE WITH G13 BASE

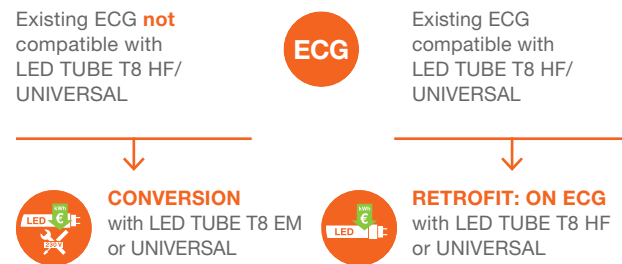
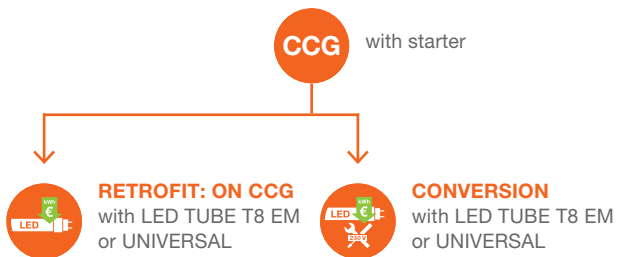

FIND THE RIGHT TECHNOLOGY: EM OR HF

Are you wondering which technology you need for your luminaire with T8 fluorescent lamp – an EM lamp or an HF lamp? Our insider tip reveals two easy ways to find out.

STARTER TEST

Check whether the luminaire you want to fit the new lamp in has a starter. If it does, you need an **LED TUBE T8 EM** for operation on a CCG. If not, use an ECG-compatible version, either **LED TUBE HF** or **UNIVERSAL**.

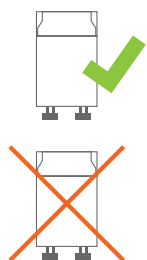

LED TUBE EM

LED TUBE HF

CAMERA TEST

If the luminaire still has a working T8 lamp, take a look at it through a digital camera (such as the one on your smartphone or tablet). If the light flickers, you need an **LED TUBE T8 EM** for operation on a CCG. Otherwise use an ECG-compatible version, either **LED TUBE HF** or **UNIVERSAL**. For the test, we recommend a maximum distance from the digital camera to the light of 30 cm.

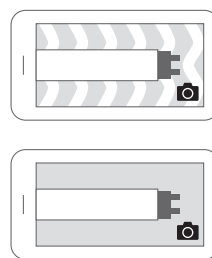

LED TUBE EM

LED TUBE HF

LED TUBES



wΔW Power in W for conventional technology

Product name	GTIN (EAN)	Segmentation	wΔW	mm	l [mm]	W	lm	lm/W	K	CRI	°	tIn ¹	IP ²	No.
--------------	------------	--------------	-----	----	--------	---	----	------	---	-----	---	------------------	-----------------	-----

LED TUBE T8 EM ULTRA OUTPUT S – High performance LED tubes for electromagnetic control gears (CCG), shatterproof

Product name	GTIN (EAN)	Segmentation	wΔW	mm	l [mm]	W	lm	lm/W	K	CRI	°	tIn ¹	IP ²	No.
LED TUBE T8 EM ULTRA OUTPUT S 1200 mm 14W 830	4099854037092	■	36	G13	1212	14.0	2340	167	3000	80	> 190	75000	IP20	1
LED TUBE T8 EM ULTRA OUTPUT S 1200 mm 14W 840	4099854037115	■	36	G13	1212	14.0	2600	185	4000	80	> 190	75000	IP20	1
LED TUBE T8 EM ULTRA OUTPUT S 1200 mm 14W 850	4099854037177	■	36	G13	1212	14.0	2600	185	5000	80	> 190	75000	IP20	1
LED TUBE T8 EM ULTRA OUTPUT S 1200 mm 14W 865	4099854037191	■	36	G13	1212	14.0	2600	185	6500	80	> 190	75000	IP20	1
LED TUBE T8 EM ULTRA OUTPUT S 1500 mm 22.2W 830	4099854037214	■	58	G13	1513	22.2	3690	166	3000	80	> 190	75000	IP20	1
LED TUBE T8 EM ULTRA OUTPUT S 1500 mm 22.1W 840	4099854037238	■	58	G13	1513	22.1	4100	185	4000	80	> 190	75000	IP20	1
LED TUBE T8 EM ULTRA OUTPUT S 1500 mm 22.1W 850	4099854037252	■	58	G13	1513	22.1	4100	185	5000	80	> 190	75000	IP20	1
LED TUBE T8 EM ULTRA OUTPUT S 1500 mm 22.1W 865	4099854037276	■	58	G13	1513	22.1	4100	185	6500	80	> 190	75000	IP20	1
LED TUBE T8 EM ULTRA OUTPUT S 1200 mm 14W 940	4099854037290	■	36	G13	1212	14.0	2600	185	4000	90	> 190	75000	IP20	1
LED TUBE T8 EM ULTRA OUTPUT S 1500 mm 22.1W 940	4099854037313	■	58	G13	1513	22.1	4100	185	4000	90	> 190	75000	IP20	1

LED TUBE T8 EM S – High performance LED tubes for electromagnetic control gears (CCG), shatterproof

Product name	GTIN (EAN)	Segmentation	wΔW	mm	l [mm]	W	lm	lm/W	K	CRI	°	tIn ¹	IP ²	No.
LED TUBE T8 EM S 438 mm 5.1W 830	4099854037337	■	15	G13	450	5.1	810	158	3000	80	> 190	75000	IP20	1
LED TUBE T8 EM S 438 mm 5.1W 840	4099854037351	■	15	G13	450	5.1	900	176	4000	80	> 190	75000	IP20	1
LED TUBE T8 EM S 438 mm 5.1W 865	4099854037375	■	15	G13	450	5.1	900	176	6500	80	> 190	75000	IP20	1
LED TUBE T8 EM S 600 mm 6.3W 830	4099854037399	■	18	G13	603	6.3	990	157	3000	80	> 190	75000	IP20	1
LED TUBE T8 EM S 600 mm 6.3W 840	4099854037412	■	18	G13	603	6.3	1100	174	4000	80	> 190	75000	IP20	1
LED TUBE T8 EM S 600 mm 6.3W 865	4099854037436	■	18	G13	603	6.3	1100	174	6500	80	> 190	75000	IP20	1
LED TUBE T8 EM S 900 mm 9.7W 830	4099854037450	■	30	G13	908	9.7	1530	157	3000	80	> 190	75000	IP20	1
LED TUBE T8 EM S 900 mm 9.7W 840	4099854037474	■	30	G13	908	9.7	1700	175	4000	80	> 190	75000	IP20	1
LED TUBE T8 EM S 900 mm 9.7W 865	4099854037498	■	30	G13	908	9.7	1700	175	6500	80	> 190	75000	IP20	1
LED TUBE T8 EM S 1050 mm 11.4W 830	4099854037511	■	38	G13	1060	11.4	1800	157	3000	80	> 190	75000	IP20	1
LED TUBE T8 EM S 1050 mm 11.4W 840	4099854037535	■	38	G13	1060	11.4	2000	175	4000	80	> 190	75000	IP20	1
LED TUBE T8 EM S 1050 mm 11.4W 865	4099854037559	■	38	G13	1060	11.4	2000	175	6500	80	> 190	75000	IP20	1
LED TUBE T8 EM S 1200 mm 12W 830	4099854037573	■	36	G13	1212	12.0	1890	157	3000	80	> 190	75000	IP20	1
LED TUBE T8 EM S 1200 mm 12W 840	4099854037597	■	36	G13	1212	12.0	2100	175	4000	80	> 190	75000	IP20	1
LED TUBE T8 EM S 1200 mm 12W 865	4099854037610	■	36	G13	1212	12.0	2100	175	6500	80	> 190	75000	IP20	1
LED TUBE T8 EM S 1500 mm 17.7W 830	4099854037634	■	58	G13	1513	17.7	2790	157	3000	80	> 190	75000	IP20	1
LED TUBE T8 EM S 1500 mm 17.7W 840	4099854037658	■	58	G13	1513	17.7	3100	175	4000	80	> 190	75000	IP20	1
LED TUBE T8 EM S 1500 mm 17.7W 865	4099854037672	■	58	G13	1513	17.7	3100	175	6500	80	> 190	75000	IP20	1

LED TUBE T8 EM ULTRA OUTPUT P – LED tubes for electromagnetic control gear (CCG), shatterproof

Product name	GTIN (EAN)	Segmentation	wΔW	mm	l [mm]	W	lm	lm/W	K	CRI	°	tIn ¹	IP ²	No.
LED TUBE T8 EM ULTRA OUTPUT P 1200 mm 15.6W 830	4099854036774	■	36	G13	1200	15.6	2250	144	3000	80	> 190	60000	IP20	1
LED TUBE T8 EM ULTRA OUTPUT P 1200 mm 15.6W 840	4099854036835	■	36	G13	1200	15.6	2500	160	4000	80	> 190	60000	IP20	1
LED TUBE T8 EM ULTRA OUTPUT P 1200 mm 15.6W 865	4099854036873	■	36	G13	1200	15.6	2500	160	6500	80	> 190	60000	IP20	1
LED TUBE T8 EM ULTRA OUTPUT P 1500 mm 23.1W 830	4099854037016	■	58	G13	1500	23.1	3330	144	3000	80	> 190	60000	IP20	1
LED TUBE T8 EM ULTRA OUTPUT P 1500 mm 23.1W 840	4099854037030	■	58	G13	1500	23.1	3700	160	4000	80	> 190	60000	IP20	1
LED TUBE T8 EM ULTRA OUTPUT P 1500 mm 23.1W 865	4099854037054	■	58	G13	1500	23.1	3700	160	6500	80	> 190	60000	IP20	1

LED TUBE T8 EM P – LED tubes for electromagnetic control gear (CCG), shatterproof

Product name	GTIN (EAN)	Segmentation	wΔW	mm	l [mm]	W	lm	lm/W	K	CRI	°	tIn ¹	IP ²	No.
LED TUBE T8 EM P 600 mm 7W 830	4099854036958	■	18	G13	603	7.0	990	141	3000	80	> 190	60000	IP20	1
LED TUBE T8 EM P 600 mm 7W 840	4099854036972	■	18	G13	603	7.0	1100	157	4000	80	> 190	60000	IP20	1
LED TUBE T8 EM P 600 mm 7W 865	4099854036996	■	18	G13	603	7.0	1100	157	6500	80	> 190	60000	IP20	1
LED TUBE T8 EM P 1200 mm 13.5W 830	4099854036897	■	36	G13	1212	13.5	1890	140	3000	80	> 190	60000	IP20	1
LED TUBE T8 EM P 1200 mm 13.5W 840	4099854036910	■	36	G13	1212	13.5	2100	155	4000	80	> 190	60000	IP20	1
LED TUBE T8 EM P 1200 mm 13.5W 865	4099854036934	■	36	G13	1212	13.5	2100	155	6500	80	> 190	60000	IP20	1
LED TUBE T8 EM P 1500 mm 20W 830	4099854037078	■	58	G13	1513	20.0	2790	139	3000	80	> 190	60000	IP20	1
LED TUBE T8 EM P 1500 mm 20W 840	4099854037139	■	58	G13	1513	20.0	3100	155	4000	80	> 190	60000	IP20	1
LED TUBE T8 EM P 1500 mm 20W 865	4099854037153	■	58	G13	1513	20.0	3100	155	6500	90	> 190	60000	IP20	1

■ SUPERIOR CLASS ■ PERFORMANCE CLASS ■ VALUE CLASS



Further information about the LED Tubes products can be found at ledvance.com/tubes

¹ L70/B50 | ² Energy efficiency class (EEC) on a scale of A (highest efficiency) to G (lowest efficiency)
³ Refer to www.ledvance.com/guarantee for precise conditions

Product name	GTIN (EAN)	Segmentation	wΔW	Im	Im/W	K	CRI	t _{in}	IP	Light No.	
LED TUBE T8 EM ULTRA OUTPUT V – Economic LED tubes for electromagnetic control gears (CCG)											
LED TUBE T8 EM ULTRA OUTPUT V 1200 mm 20W 830	4099854038327	■	36	G13	1213	20.0	2160	108	3000	80 > 190 30000	1
LED TUBE T8 EM ULTRA OUTPUT V 1200 mm 20W 840	4099854038402	■	36	G13	1213	20.0	2400	120	4000	80 > 190 30000	1
LED TUBE T8 EM ULTRA OUTPUT V 1200 mm 20W 865	4099854038525	■	36	G13	1213	20.0	2400	120	6500	≥ 80 > 190 30000	1
LED TUBE T8 EM ULTRA OUTPUT V 1500 mm 29W 830	4099854038624	■	58	G13	1514	29.0	3150	108	3000	80 > 190 30000	1
LED TUBE T8 EM ULTRA OUTPUT V 1500 mm 29W 840	4099854038662	■	58	G13	1514	29.0	3500	120	4000	80 > 190 30000	1
LED TUBE T8 EM ULTRA OUTPUT V 1500 mm 29W 865	4099854038747	■	58	G13	1514	29.0	3500	120	6500	80 > 190 30000	1
LED TUBE T8 EM V – Economic LED tubes for electromagnetic control gears (CCG)											
LED TUBE T8 EM V 438 mm 5.4W 830	4099854038907	■	15	G13	451	5.4	585	108	3000	80 > 190 30000	1
LED TUBE T8 EM V 438 mm 5.4W 840	4099854038921	■	15	G13	451	5.4	650	120	4000	80 > 190 30000	1
LED TUBE T8 EM V 438 mm 5.4W 865	4099854038945	■	15	G13	451	5.4	650	120	6500	80 > 190 30000	1
LED TUBE T8 EM V 600 mm 6.6W 830	4099854038969	■	18	G13	604	6.6	720	109	3000	80 > 190 30000	1
LED TUBE T8 EM V 600 mm 6.6W 840	4099854038983	■	18	G13	604	6.6	800	121	4000	80 > 190 30000	1
LED TUBE T8 EM V 600 mm 6.6W 865	4099854039003	■	18	G13	604	6.6	800	121	6500	80 > 190 30000	1
LED TUBE T8 EM V 720 mm 7W 830	4099854039027	■	16	G13	734	7.0	765	109	3000	80 > 190 30000	1
LED TUBE T8 EM V 720 mm 7W 840	4099854039041	■	16	G13	734	7.0	850	121	4000	80 > 190 30000	1
LED TUBE T8 EM V 720 mm 7W 865	4099854039065	■	16	G13	734	7.0	850	121	6500	80 > 190 30000	1
LED TUBE T8 EM V 900 mm 10W 830	4099854039102	■	30	G13	908	10.0	1080	108	3000	80 > 190 30000	1
LED TUBE T8 EM V 900 mm 10W 840	4099854039126	■	30	G13	908	10.0	1200	120	4000	80 > 190 30000	1
LED TUBE T8 EM V 900 mm 10W 865	4099854039164	■	30	G13	908	10.0	1200	120	6500	80 > 190 30000	1
LED TUBE T8 EM V 1050 mm 11.6W 830	4099854039201	■	38	G13	1061	11.6	1260	108	3000	80 > 190 30000	1
LED TUBE T8 EM V 1050 mm 11.6W 840	4099854039249	■	38	G13	1061	11.6	1400	120	4000	≥ 80 > 190 30000	1
LED TUBE T8 EM V 1050 mm 11.6W 865	4099854038488	■	38	G13	1061	11.6	1400	120	6500	80 > 190 30000	1
LED TUBE T8 EM V 1200 mm 15W 830	4099854038143	■	36	G13	1213	15.0	1620	108	3000	80 > 190 30000	1
LED TUBE T8 EM V 1200 mm 15W 840	4099854038167	■	36	G13	1213	15.0	1800	120	4000	80 > 190 30000	1
LED TUBE T8 EM V 1200 mm 15W 865	4099854038181	■	36	G13	1213	15.0	1800	120	6500	80 > 190 30000	1
LED TUBE T8 EM V 1500 mm 18.3W 830	4099854038204	■	58	G13	1514	18.3	2000	109	3000	80 > 190 30000	1
LED TUBE T8 EM V 1500 mm 18.3W 840	4099854038228	■	58	G13	1514	18.3	2200	120	4000	80 > 190 30000	1
LED TUBE T8 EM V 1500 mm 18.3W 865	4099854038242	■	58	G13	1514	18.3	2200	120	6500	80 > 190 30000	1
LED TUBE T8 EM ULTRA OUTPUT HIGH TEMPERATURE S – High performance LED tubes for electromagnetic control gear (CCG) and AC mains, for applications with high ambient temperature											
LED TUBE T8 EM ULTRA OUTPUT HIGH TEMPERATURE S 1200 mm 14W 840	4099854258572	■	36	G13	1213	14.0	2600	185	4000	80 120 75000	3
LED TUBE T8 EM ULTRA OUTPUT HIGH TEMPERATURE S 1500 mm 22W 840	4099854258596	■	58	G13	1514	22.1	4100	185	4000	80 120 75000	3
LED TUBE T8 EM ULTRA OUTPUT HIGHBAY S – High performance LED tubes for electromagnetic control gear (CCG) and AC mains, and for high bay applications											
LED TUBE T8 EM ULTRA OUTPUT HIGHBAY S 1200 mm 14W 840	4099854258633	■	36	G13	1213	14.0	2600	185	4000	80 90 75000	4
LED TUBE T8 EM ULTRA OUTPUT HIGHBAY S 1500 mm 22.1W 840	4099854258671	■	58	G13	1514	22.1	4100	185	4000	80 90 75000	4
LED TUBE T8 EM ULTRA OUTPUT 6 kV S – High performance LED tubes for electromagnetic control gear (CCG) and AC mains, 6 kV surge protection, shatterproof											
LED TUBE T8 EM ULTRA OUTPUT 6kV S 1200 mm 14W 840	4099854147791	■	36	G13	1212	14.0	2600	185	4000	80 190 75000	2
LED TUBE T8 EM ULTRA OUTPUT 6kV S 1500 mm 22.1W 840	4099854147814	■	58	G13	1513	22.1	4100	185	4000	80 190 75000	2
LED TUBE T8 EM CHIP CONTROL S – High performance LED tubes for electromagnetic control gear (CCG) and AC mains, with UV filter sleeves											
LED TUBE T8 EM CHIP CONTROL S 1200 mm 18W	4099854271472	■	36	G13	1212	18.0	2000	111	2000	35 190 50000	5
LED TUBE T8 EM CHIP CONTROL S 1500 mm 23W	4099854271496	■	58	G13	1513	23.0	2500	108	2000	35 190 50000	5
LED TUBE T8 EM ENERGY EFFICIENCY CLASS A S – High performance LED tubes for electromagnetic control gear (CCG) and AC mains, EEC A											
LED TUBE T8 EM ENERGY EFFICIENCY CLASS A S 1200 mm 10W 840	4099854223310	■	36	G13	1212	10.0	2100	210	4000	80 190 100000	2
LED TUBE T8 EM ENERGY EFFICIENCY CLASS A S 1500 mm 17.6W 840	4099854223334	■	58	G13	1513	17.6	3700	210	4000	80 190 100000	2
LED TUBE T8 EM MOTION SENSOR P – LED tubes with integrated microwave sensor for electromagnetic control gears (CCG), shatterproof											
LED TUBE T8 EM MOTION SENSOR P 600 mm 6.8W 840	4099854044472	■	18	G13	603	6.8	1100	161	4000	80 > 190 60000	1
LED TUBE T8 EM MOTION SENSOR P 1200 mm 13.1W 840	4099854044960	■	36	G13	1212	13.1	2100	160	4000	80 > 190 60000	1
LED TUBE T8 EM MOTION SENSOR P 1500 mm 19.3W 840	4099854045066	■	58	G13	1513	19.3	3100	160	4000	80 > 190 60000	1



Further information about the LED Tubes products can be found at ledvance.com/tubes

■ SUPERIOR CLASS ■ PERFORMANCE CLASS ■ VALUE CLASS

¹ L70/B50 | ² Energy efficiency class (EEC) on a scale of A (highest efficiency) to G (lowest efficiency) | ³ Refer to www.ledvance.com/guarantee for precise conditions | ⁴ 2 years guarantee for operation between T_c 61 °C and T_c max., 5 years guarantee for operation at T_c ≤ 60 °C. Refer to www.ledvance.com/guarantee for precise conditions

LED TUBES



wΔW Power in W for conventional technology

Product name	GTIN (EAN)	Segmentation	wΔW	Im	I [mm]	W	lm	lm/W	K	CRI	t _{in}	1	2	No.
--------------	------------	--------------	-----	----	--------	---	----	------	---	-----	-----------------	---	---	-----

LED TUBE T8 EM FOOD P – LED tubes for electromagnetic control gears (CCG), shatterproof, for food presentation

LED TUBE T8 EM FOOD P 600 mm 5.2W 833	4099854044793	■	18	G13	603	5.2	500	96	3300	80	>190	60000	—	1
LED TUBE T8 EM FOOD P 900 mm 7.9W 833	4099854045226	■	30	G13	908	7.9	750	94	3300	80	>190	60000	—	1
LED TUBE T8 EM FOOD P 1200 mm 11.6W 833	4099854045004	■	36	G13	1212	11.6	1100	94	3300	80	>190	60000	—	1
LED TUBE T8 EM FOOD P 1500 mm 17.9W 833	4099854045127	■	58	G13	1513	17.9	1700	94	3300	80	>190	60000	—	1

LED TUBE T8 EM CONNECTED P – LED tube for electromagnetic control gears works with Connected Sensors

LED TUBE T8 EM CON P 600 mm 7.5W 840	4058075823938	■	18	G13	603	7.5	1100	146	4000	80	160	50000	▶	2
LED TUBE T8 EM CON P 600 mm 7.5W 865	4058075823952	■	18	G13	603	7.5	1100	146	6500	80	160	50000	▶	2
LED TUBE T8 EM CON P 1200 mm 16W 840	4058075823976	■	36	G13	1213	16.0	2400	150	4000	80	160	50000	▶	2
LED TUBE T8 EM CON P 1200 mm 16W 865	4058075823990	■	36	G13	1213	16.0	2400	150	6500	80	160	50000	▶	2
LED TUBE T8 EM CON P 1500 mm 24W 840	4058075824010	■	58	G13	1513	24.0	3600	150	4000	80	160	50000	▶	2
LED TUBE T8 EM CON P 1500 mm 24W 865	4058075824034	■	58	G13	1513	24.0	3600	150	6500	80	160	50000	▶	2

Product name	GTIN (EAN)	I [mm]	No.
--------------	------------	--------	-----

LED TUBE T8 EM STARTER – Starter for LED TUBE T8 EM (CCG)

LED TUBE T8 EM STARTER	4099854067150	40	20	3
------------------------	---------------	----	----	---

LED TUBE CONVERSION KIT – contains all necessary material for conversion of luminaires to AC mains

LED TUBE CONVERSION KIT 1 LAMP	4058118280612	—	—	4
LED TUBE CONVERSION KIT 2 LAMPS	4058118280636	—	—	5

Product name	GTIN (EAN)	INFRARED	L × W × H [mm]	V _{DC}	t _{in}	1	kHz ECG	IP	No.
--------------	------------	----------	----------------	-----------------	-----------------	---	---------	----	-----

LEDVANCE CONNECTED SENSOR – Sensor for LED TUBE Connected TUBE

CONNECTED SENSOR LB	4058075232969	Passive infrared (PIR)	95 × 95 × 65	360	220...240	50000	50	27	6
CONNECTED SENSOR HB	4058075232983	Passive infrared (PIR)	95 × 95 × 65	180	220...240	50000	50	27	6

LEDVANCE CONNECTED SENSOR REMOTE – Connected Sensor Remote for LEDVANCE Connected Sensor HB and LB

CONNECTED SENSOR REMOTE CONTROL	4058075374034	—	58 × 94 × 8	15	—	—	—	10	7
---------------------------------	---------------	---	-------------	----	---	---	---	----	---

Product name	GTIN (EAN)	Segmentation	wΔW	Im	I [mm]	W	lm	lm/W	K	CRI	t _{in}	1	2	No.
--------------	------------	--------------	-----	----	--------	---	----	------	---	-----	-----------------	---	---	-----

LED TUBE T8 UNIVERSAL ULTRA OUTPUT P – LED tubes for electronic control gears (ECG), electromagnetic control gears (CCG) and mains, shatterproof

LED TUBE T8 UNIVERSAL ULTRA OUTPUT P 1200 mm 15W 840	4099854026294	■	36	G13	1211	15.0	2400	160	4000	80	190	60000	▶	8
LED TUBE T8 UNIVERSAL ULTRA OUTPUT P 1200 mm 15W 865	4099854026331	■	36	G13	1211	15.0	2400	160	6500	80	190	60000	▶	8
LED TUBE T8 UNIVERSAL ULTRA OUTPUT P 1500 mm 23W 840	4099854026577	■	58	G13	1513	23.0	3700	160	4000	80	190	60000	▶	9
LED TUBE T8 UNIVERSAL ULTRA OUTPUT P 1500 mm 23W 865	4099854026591	■	58	G13	1513	23.0	3700	160	6500	80	190	60000	▶	9

LED TUBE T8 UNIVERSAL P – LED tubes for electronic control gears (ECG), electromagnetic control gears (CCG) and mains, shatterproof

LED TUBE T8 UNIVERSAL P 600 mm 7.5W 830	4099854026119	■	18	G13	603	7.5	1100	146	3000	80	190	60000	▶	10
LED TUBE T8 UNIVERSAL P 600 mm 7.5W 840	4099854026157	■	18	G13	603	7.5	1100	146	4000	80	190	60000	▶	10
LED TUBE T8 UNIVERSAL P 600 mm 7.5W 865	4099854026218	■	18	G13	603	7.5	1000	133	6500	80	190	60000	▶	10
LED TUBE T8 UNIVERSAL P 1200 mm 14W 830	4099854026492	■	36	G13	1211	14.0	1900	135	3000	80	190	60000	▶	8
LED TUBE T8 UNIVERSAL P 1200 mm 14W 840	4099854026393	■	36	G13	1211	14.0	2100	150	4000	80	190	60000	▶	8
LED TUBE T8 UNIVERSAL P 1200 mm 14W 865	4099854026430	■	36	G13	1211	14.0	2100	150	6500	80	190	60000	▶	8
LED TUBE T8 UNIVERSAL P 1500 mm 20W 830	4099854026652	■	58	G13	1513	20.0	2800	140	3000	80	190	60000	▶	9
LED TUBE T8 UNIVERSAL P 1500 mm 20W 840	4099854026614	■	58	G13	1513	20.0	3100	155	4000	80	190	60000	▶	9
LED TUBE T8 UNIVERSAL P 1500 mm 20W 865	4099854026638	■	58	G13	1513	20.0	3100	155	6500	80	190	60000	▶	9

Product name	GTIN (EAN)	Segmentation	wΔW				W	lm	lm/W	K	CRI		t _{in}		No.
--------------	------------	--------------	-----	--	--	--	---	----	------	---	-----	--	-----------------	--	-----

LED TUBE T8 UNIVERSAL V – LED tubes for electronic control gears (ECG), electromagnetic control gears (CCG) and mains

LED TUBE T8 UNIVERSAL V 600 mm 8W 830	4099854026515	■	18	G13	603	8.0	800	100	3000	80	190	30000		10
LED TUBE T8 UNIVERSAL V 600 mm 8W 840	4099854026539	■	18	G13	603	8.0	900	112	4000	80	190	30000		10
LED TUBE T8 UNIVERSAL V 600 mm 8W 865	4099854026553	■	18	G13	603	8.0	900	112	6500	80	190	30000		10
LED TUBE T8 UNIVERSAL V 1200 mm 18W 830	4099854026317	■	36	G13	1211	18.0	1850	102	3000	80	190	30000		8
LED TUBE T8 UNIVERSAL V 1200 mm 18W 840	4099854026355	■	36	G13	1211	18.0	2000	111	4000	80	190	30000		8
LED TUBE T8 UNIVERSAL V 1200 mm 18W 865	4099854026379	■	36	G13	1211	18.0	2000	111	6500	80	190	30000		8
LED TUBE T8 UNIVERSAL V 1500 mm 24W 830	4099854026416	■	58	G13	1513	24.0	2550	106	3000	80	190	30000		9
LED TUBE T8 UNIVERSAL V 1500 mm 24W 840	4099854026454	■	58	G13	1513	24.0	2800	116	4000	80	190	30000		9
LED TUBE T8 UNIVERSAL V 1500 mm 24W 865	4099854026478	■	58	G13	1513	24.0	2800	116	6500	80	190	30000		9

LED TUBE T8 HF ULTRA OUTPUT P – LED tubes for electronic high frequency control gears (ECG), shatterproof

LED TUBE T8 HF ULTRA OUTPUT P 1200 mm 15W 840	4099854026133	■	36	G13	1211	15.0	2400	160	4000	80	190	75000		8
LED TUBE T8 HF ULTRA OUTPUT P 1200 mm 15W 865	4099854026171	■	36	G13	1211	15.0	2400	160	6500	80	190	75000		8
LED TUBE T8 HF ULTRA OUTPUT P 1500 mm 23W 840	4099854026195	■	58	G13	1513	23.0	3700	160	4000	80	190	75000		9
LED TUBE T8 HF ULTRA OUTPUT P 1500 mm 23W 865	4099854026232	■	58	G13	1513	23.0	3700	160	6500	80	190	75000		9

LED TUBE T8 HF P – LED tubes for electronic high frequency control gears (ECG), shatterproof

LED TUBE T8 HF P 600 mm 7.5W 830	4099854026058	■	18	G13	603	7.5	1000	133	3000	80	190	75000		10
LED TUBE T8 HF P 600 mm 7.5W 840	4099854026072	■	18	G13	603	7.5	1100	146	4000	80	190	75000		10
LED TUBE T8 HF P 600 mm 7.5W 865	4099854026096	■	18	G13	603	7.5	1100	146	6500	80	190	75000		10
LED TUBE T8 HF P 1200 mm 14W 830	4099854025914	■	36	G13	1211	14.0	1900	135	3000	80	190	75000		8

LED TUBE T8 HF P – LED tubes for electronic high frequency control gears (ECG), shatterproof

LED TUBE T8 HF P 1200 mm 14W 840	4099854025938	■	36	G13	1211	14.0	2100	150	4000	80	190	75000		8
LED TUBE T8 HF P 1200 mm 14W 865	4099854025952	■	36	G13	1211	14.0	2100	150	6500	80	190	75000		8
LED TUBE T8 HF P 1500 mm 20W 830	4099854025976	■	58	G13	1513	20.0	2800	140	3000	80	190	75000		9
LED TUBE T8 HF P 1500 mm 20W 840	4099854025990	■	58	G13	1513	20.0	3100	155	4000	80	190	75000		9
LED TUBE T8 HF P 1500 mm 20W 865	4099854026010	■	58	G13	1513	20.0	3100	155	6500	80	190	75000		9

LED TUBE T8 HF V – Economic LED tubes for electronic high frequency control gears (ECG)

LED TUBE T8 HF V 600 mm 8W 840	4099854026256	■	18	G13	603	8.0	900	112	4000	80	190	30000		10
LED TUBE T8 HF V 600 mm 8W 865	4099854026270	■	18	G13	603	8.0	900	112	6500	80	190	30000		10

LED TUBE T5 HF P – LED tubes for electronic high frequency control gears

LED TUBE T5 HF HE14 P 549 mm 7W 830	4099854029448	■	14	G5	549	7.0	900	128	3000	80	190	50000		11
LED TUBE T5 HF HE14 P 549 mm 7W 840	4099854029462	■	14	G5	549	7.0	1000	142	4000	80	190	50000		11
LED TUBE T5 HF HE14 P 549 mm 7W 865	4099854029486	■	14	G5	549	7.0	1000	142	6500	80	190	50000		11
LED TUBE T5 HF HE21 P 849 mm 10W 830	4099854029387	■	21	G5	849	10.0	1350	135	3000	80	190	50000		11
LED TUBE T5 HF HE21 P 849 mm 10W 840	4099854029400	■	21	G5	849	10.0	1500	150	4000	80	190	50000		11
LED TUBE T5 HF HE21 P 849 mm 10W 865	4099854029424	■	21	G5	849	10.0	1500	150	6500	80	190	50000		11
LED TUBE T5 HF HE28 P 1149 mm 16W 830	4099854029325	■	28	G5	1149	16.0	2160	135	3000	80	190	50000		11
LED TUBE T5 HF HE28 P 1149 mm 16W 840	4099854029349	■	28	G5	1149	16.0	2400	150	4000	80	190	50000		11
LED TUBE T5 HF HE28 P 1149 mm 16W 865	4099854029363	■	28	G5	1149	16.0	2400	150	6500	80	190	50000		11
LED TUBE T5 HF HE35 P 1449 mm 18W 830	4099854029172	■	35	G5	1449	18.0	2550	141	3000	80	190	50000		11
LED TUBE T5 HF HE35 P 1449 mm 18W 840	4099854029196	■	35	G5	1449	18.0	2800	155	4000	80	190	50000		11
LED TUBE T5 HF HE35 P 1449 mm 18W 865	4099854029219	■	35	G5	1449	18.0	2800	155	6500	80	190	50000		11
LED TUBE T5 HF HO49 P 1449 mm 26W 830	4099854029110	■	49	G5	1449	26.0	3600	138	3000	80	190	50000		11
LED TUBE T5 HF HO49 P 1449 mm 26W 840	4099854029134	■	49	G5	1449	26.0	4000	153	4000	80	190	50000		11
LED TUBE T5 HF HO49 P 1449 mm 26W 865	4099854029158	■	49	G5	1449	26.0	4000	153	6500	80	190	50000		11
LED TUBE T5 HF HO54 P 1149 mm 26W 830	4099854029257	■	54	G5	1149	26.0	3600	138	3000	80	190	50000		11
LED TUBE T5 HF HO54 P 1149 mm 26W 840	4099854029271	■	54	G5	1149	26.0	4000	153	4000	80	190	50000		11
LED TUBE T5 HF HO54 P 1149 mm 26W 865	4099854029301	■	54	G5	1149	26.0	4000	153	6500	80	190	50000		11
LED TUBE T5 HF HO80 P 1449 mm 36W 830	4099854029059	■	80	G5	1449	36.0	5050	140	3000	80	190	50000		11
LED TUBE T5 HF HO80 P 1449 mm 36W 840	4099854029073	■	80	G5	1449	36.0	5600	155	4000	80	190	50000		11
LED TUBE T5 HF HO80 P 1449 mm 36W 865	4099854029097	■	80	G5	1449	36.0	5600	155	6500	80	190	50000		11

■ SUPERIOR CLASS ■ PERFORMANCE CLASS ■ VALUE CLASS



Check ECG compatibility at ledvance.com/compatibility or ledvance.com/tubefinder

¹ L70/B50 | ² Energy efficiency class (EEC) on a scale of A (highest efficiency) to G (lowest efficiency) | ³ Refer to www.ledvance.com/guarantee for precise conditions | ⁴ Check ECG compatibility at ledvance.com/compatibility or ledvance.com/tubefinder

LED TUBES



wΔW Power in W for conventional technology

Product name	GTIN (EAN)	Segmentation	wΔW	mm	L [mm]	W	lm	lm/W	K	CRI	°	tIn ¹	IP ²	No.
--------------	------------	--------------	-----	----	--------	---	----	------	---	-----	---	------------------	-----------------	-----

LED TUBE T5 HF SHORT V – LED tubes for electronic high frequency control gears

Product name	GTIN (EAN)	Segmentation	wΔW	mm	L [mm]	W	lm	lm/W	K	CRI	°	tIn ¹	IP ²	No.
LED TUBE T5 HF L8 SHORT V 288 mm 4W 830	4058075823617	■	8	G5	288	4.0	380	95	3000	80	190	30000	▶	2
LED TUBE T5 HF L8 SHORT V 288 mm 4W 840	4058075823631	■	8	G5	288	4.0	400	100	4000	80	190	30000	▶	2
LED TUBE T5 HF L13 SHORT V 517 mm 7W 830	4058075823655	■	13	G5	517	7.0	770	110	3000	80	190	30000	▶	2
LED TUBE T5 HF L13 SHORT V 517 mm 7W 840	4058075823679	■	13	G5	517	7.0	850	121	4000	80	190	30000	▶	2

LED TUBE T5 AC MAINS P – LED tubes for operation on AC mains connection

Product name	GTIN (EAN)	Segmentation	wΔW	mm	L [mm]	W	lm	lm/W	K	CRI	°	tIn ¹	IP ²	No.
LED TUBE T5 AC HE14 P 549 mm 7W 830	4058075824416	■	14	G5	549	7.0	900	128	3000	80	190	50000	▶	1
LED TUBE T5 AC HE14 P 549 mm 7W 840	4058075824430	■	14	G5	549	7.0	1000	142	4000	80	190	50000	▶	1
LED TUBE T5 AC HE14 P 549 mm 7W 865	4058075824454	■	14	G5	549	7.0	1000	142	6500	80	190	50000	▶	1
LED TUBE T5 AC HE21 P 849 mm 10W 830	4058075824355	■	21	G5	849	10.0	1350	135	3000	80	190	50000	▶	1
LED TUBE T5 AC HE21 P 849 mm 10W 840	4058075824379	■	21	G5	849	10.0	1500	150	4000	80	190	50000	▶	1
LED TUBE T5 AC HE21 P 849 mm 10W 865	4058075824393	■	21	G5	849	10.0	1500	150	6500	80	190	50000	▶	1
LED TUBE T5 AC HO24 P 549 mm 10W 830	4099854081200	■	24	G5	549	10.0	1350	135	3000	80	190	50000	▶	1
LED TUBE T5 AC HO24 P 549 mm 10W 840	4099854081224	■	24	G5	549	10.0	1500	150	4000	80	190	50000	▶	1
LED TUBE T5 AC HO24 P 549 mm 10W 865	4099854081248	■	24	G5	549	10.0	1500	150	6500	80	190	50000	▶	1
LED TUBE T5 AC HO39 P 849 mm 16W 830	4099854081149	■	39	G5	849	16.0	2160	135	3000	80	190	50000	▶	1
LED TUBE T5 AC HO39 P 849 mm 16W 840	4099854081163	■	39	G5	849	16.0	2400	150	4000	80	190	50000	▶	1
LED TUBE T5 AC HO39 P 849 mm 16W 865	4099854081187	■	39	G5	849	16.0	2400	150	6500	80	190	50000	▶	1
LED TUBE T5 AC HE28 P 1149 mm 16W 830	4058075824294	■	28	G5	1149	16.0	2150	134	3000	80	190	50000	▶	1
LED TUBE T5 AC HE28 P 1149 mm 16W 840	4058075824317	■	28	G5	1149	16.0	2400	150	4000	80	190	50000	▶	1
LED TUBE T5 AC HE28 P 1149 mm 16W 865	4058075824331	■	28	G5	1149	16.0	2400	150	6500	80	190	50000	▶	1
LED TUBE T5 AC HE35 P 1449 mm 18W 830	4058075824232	■	35	G5	1449	18.0	2550	141	3000	80	190	50000	▶	1
LED TUBE T5 AC HE35 P 1449 mm 18W 840	4058075824256	■	35	G5	1449	18.0	2800	155	4000	80	190	50000	▶	1
LED TUBE T5 AC HE35 P 1449 mm 18W 865	4058075824270	■	35	G5	1449	18.0	2800	155	6500	80	190	50000	▶	1
LED TUBE T5 AC HO49 P 1449 mm 26W 830	4058075824171	■	49	G5	1449	26.0	3600	138	3000	80	190	50000	▶	1
LED TUBE T5 AC HO49 P 1449 mm 26W 840	4058075824195	■	49	G5	1449	26.0	4000	153	4000	80	190	50000	▶	1
LED TUBE T5 AC HO49 P 1449 mm 26W 865	4058075824218	■	49	G5	1449	26.0	4000	153	6500	80	190	50000	▶	1
LED TUBE T5 AC HO54 P 1149 mm 26W 830	4058075824119	■	54	G5	1149	26.0	3600	138	3000	80	190	50000	▶	1
LED TUBE T5 AC HO54 P 1149 mm 26W 840	4058075824133	■	54	G5	1149	26.0	4000	153	4000	80	190	50000	▶	1
LED TUBE T5 AC HO54 P 1149 mm 26W 865	4058075824157	■	54	G5	1149	26.0	4000	153	6500	80	190	50000	▶	1
LED TUBE T5 AC HO80 P 1449 mm 36W 830	4058075824058	■	80	G5	1449	36.0	5050	140	3000	80	190	50000	▶	1
LED TUBE T5 AC HO80 P 1449 mm 36W 840	4058075824072	■	80	G5	1449	36.0	5600	155	4000	80	190	50000	▶	1
LED TUBE T5 AC HO80 P 1449 mm 36W 865	4058075824096	■	80	G5	1449	36.0	5600	155	6500	80	190	50000	▶	1

LED T5 FC EXTERNAL P – LED T5 FC EXTERNAL with LED DRIVER DALI

Product name	GTIN (EAN)	Segmentation	wΔW	mm	L [mm]	W	lm	lm/W	K	CRI	°	tIn ¹	IP ²	No.
LED T5 FC 22 EXTERNAL P 11.6W 830 2GX13	4099854300806	■	22	2GX13	225	11.6	1550	133	3000	80	120	50000	▶	4
LED T5 FC 22 EXTERNAL P 11.6W 840 2GX13	4099854300820	■	22	2GX13	225	11.6	1700	146	4000	80	120	50000	▶	4
LED T5 FC 22 EXTERNAL P 11.6W 865 2GX13	4099854300844	■	22	2GX13	225	11.6	1700	146	6500	80	120	50000	▶	4
LED T5 FC 40/55 EXTERNAL P 21.5W 830 2GX13	4099854300868	■	40/55	2GX13	300	21.5	2900	134	3000	80	120	50000	▶	4
LED T5 FC 40/55 EXTERNAL P 21.5W 840 2GX13	4099854300882	■	40/55	2GX13	300	21.5	3200	148	4000	80	120	50000	▶	4
LED T5 FC 40/55 EXTERNAL P 21.5W 865 2GX13	4099854300905	■	40/55	2GX13	300	21.5	3200	148	6500	80	120	50000	▶	4

LED TUBE T8 EXTERNAL P – LED TUBE T8 EXTERNAL for LED DRIVER EXTERNAL⁷

Product name	GTIN (EAN)	Segmentation	wΔW	mm	L [mm]	W	lm	lm/W	K	CRI	°	tIn ¹	IP ²	No.
LED TUBE T8 EXTERNAL P 600 mm 7.3W 830	4099854294426	■	18	G13	603	7.3	1000	136	3000	80	190	75000	▶	3
LED TUBE T8 EXTERNAL P 600 mm 7.3W 840	4099854294440	■	18	G13	603	7.3	1100	150	4000	80	190	75000	▶	3
LED TUBE T8 EXTERNAL P 600 mm 7.3W 865	4099854294464	■	18	G13	603	7.3	1100	150	6500	80	190	75000	▶	3
LED TUBE T8 EXTERNAL P 1200 mm 15W 830	4099854015281	■	36	G13	1213	15.0	2160	144	3000	80	190	50000	▶	3
LED TUBE T8 EXTERNAL P 1200 mm 15W 840	4058075730595	■	36	G13	1213	15.0	2400	160	4000	80	190	50000	▶	3
LED TUBE T8 EXTERNAL P 1200 mm 15W 865	4058075730618	■	36	G13	1213	15.0	2400	160	6500	80	190	50000	▶	3
LED TUBE T8 EXTERNAL P 1500 mm 23W 830	4099854015328	■	58	G13	1513	23.0	3350	145	3000	80	190	50000	▶	3
LED TUBE T8 EXTERNAL P 1500 mm 23W 840	4058075730557	■	58	G13	1513	23.0	3700	160	4000	80	190	50000	▶	3
LED TUBE T8 EXTERNAL P 1500 mm 23W 865	4058075730571	■	58	G13	1513	23.0	3700	160	6500	80	190	50000	▶	3

Product name	GTIN (EAN)	Segmentation	wΔW		$\frac{l}{[mm]}$	W	lm	$\frac{lm}{W}$	K	CRI	α	t_{inj}		
LED TUBE T5 EXTERNAL P – LED TUBE T5 EXTERNAL for LED DRIVER EXTERNAL⁷														
LED TUBE T5 EXTERNAL HE14 P 549 mm 7.3W 830	4099854294082	■	14	G5	563	7.3	1000	136	3000	80	180	75000		4
LED TUBE T5 EXTERNAL HE14 P 549 mm 7.3W 840	4099854294105	■	14	G5	563	7.3	1100	150	4000	80	180	75000		4
LED TUBE T5 EXTERNAL HE14 P 549 mm 7.3W 865	4099854294129	■	14	G5	563	7.3	1100	150	6500	80	180	75000		4
LED TUBE T5 EXTERNAL HE21 P 849 mm 10.5W 830	4099854294150	■	21	G5	863	10.5	1450	138	3000	80	180	75000		4
LED TUBE T5 EXTERNAL HE21 P 849 mm 10.5W 840	4099854294181	■	21	G5	863	10.5	1600	152	4000	80	180	75000		4
LED TUBE T5 EXTERNAL HE21 P 849 mm 10.5W 865	4099854294204	■	21	G5	863	10.5	1600	152	6500	80	180	75000		4
LED TUBE T5 EXTERNAL HO24 P 549 mm 10.5W 830	4099854294228	■	24	G5	563	10.5	1450	138	3000	80	180	75000		4
LED TUBE T5 EXTERNAL HO24 P 549 mm 10.5W 840	4099854294242	■	24	G5	563	10.5	1600	152	4000	80	180	75000		4
LED TUBE T5 EXTERNAL HO24 P 549 mm 10.5W 865	4099854294266	■	24	G5	563	10.5	1600	152	6500	80	180	75000		4
LED TUBE T5 EXTERNAL HE28 P 1149 mm 16W 830	4099854294303	■	28	G5	1163	16.0	2160	135	3000	80	180	75000		4
LED TUBE T5 EXTERNAL HE28 P 1149 mm 16W 840	4099854294327	■	28	G5	1163	16.0	2400	150	4000	80	180	75000		4
LED TUBE T5 EXTERNAL HE28 P 1149 mm 16W 865	4099854294341	■	28	G5	1163	16.0	2400	150	6500	80	180	75000		4
LED TUBE T5 EXTERNAL HE35 P 1449 mm 18W 830	4099854015151	■	35	G5	1463	18.0	2550	141	3000	80	180	50000		4
LED TUBE T5 EXTERNAL HE35 P 1449 mm 18W 840	4058075730519	■	35	G5	1463	18.0	2800	155	4000	80	180	50000		4
LED TUBE T5 EXTERNAL HE35 P 1449 mm 18W 865	4058075730533	■	35	G5	1463	18.0	2800	155	6500	80	180	50000		4
LED TUBE T5 EXTERNAL HO39 P 849 mm 17W 830	4099854294365	■	39	G5	863	17.0	2350	138	3000	80	180	75000		4
LED TUBE T5 EXTERNAL HO39 P 849 mm 17W 840	4099854294389	■	39	G5	863	17.0	2600	152	4000	80	180	75000		4
LED TUBE T5 EXTERNAL HO39 P 849 mm 17W 865	4099854294402	■	39	G5	863	17.0	2600	152	6500	80	180	75000		4
LED TUBE T5 EXTERNAL HO49 P 1449 mm 26W 830	4099854015175	■	49	G5	1463	26.0	3600	138	3000	80	180	50000		4
LED TUBE T5 EXTERNAL HO49 P 1449 mm 26W 840	4058075730434	■	49	G5	1463	26.0	4000	153	4000	80	180	50000		4
LED TUBE T5 EXTERNAL HO49 P 1449 mm 26W 865	4058075730458	■	49	G5	1463	26.0	4000	153	6500	80	180	50000		4
LED TUBE T5 EXTERNAL HO54 P 1149 mm 26W 830	4099854015199	■	54	G5	1163	26.0	3600	138	3000	80	180	50000		4
LED TUBE T5 EXTERNAL HO54 P 1149 mm 26W 840	4058075730472	■	54	G5	1163	26.0	4000	153	4000	80	180	50000		4
LED TUBE T5 EXTERNAL HO54 P 1149 mm 26W 865	4058075730496	■	54	G5	1163	26.0	4000	153	6500	80	180	50000		4
LED TUBE T5 EXTERNAL HO80 P 1449 mm 37W 830	4099854015267	■	80	G5	1463	37.0	5050	136	3000	80	180	50000		4
LED TUBE T5 EXTERNAL HO80 P 1449 mm 37W 840	4058075730410	■	80	G5	1463	37.0	5600	151	4000	80	180	50000		4
LED TUBE T5 EXTERNAL HO80 P 1449 mm 37W 865	4058075730397	■	80	G5	1463	37.0	5600	151	6500	80	180	50000		4

Product name	GTIN (EAN)	Segmentation	W	L × W × H [mm]	t_{inj}	H _z	
LED DRIVER LED TUBE EXTERNAL DALI P – Constant current LED DRIVER EXTERNAL for LED TUBE EXTERNAL T5/T8 – indoor							
DR EXT DALI-P -1X7-37W 220-240	4099854295157	■	38.7	284 × 31 × 21	100000	0/50/60	25
DR EXT DALI-P -2X7-26W 220-240	4099854295171	■	54.0	360 × 31 × 21	100000	0/50/60	25

Product name	GTIN (EAN)	Segmentation	wΔW		$\frac{l}{[mm]}$	W	lm	$\frac{lm}{W}$	K	CRI	α	t_{inj}		
LED TUBE T9 EM V – Circular LED tube for electromagnetic control gear (CCG) and AC mains														
LED TUBE T9 C 22 EM V 11W 830 G10Q	4099854042447	■	22	G10q	212	11.0	1200	109	3000	≥80	110	30000		7
LED TUBE T9 C 22 EM V 11W 840 G10Q	4099854042461	■	22	G10q	212	11.0	1320	120	4000	≥80	110	30000		7
LED TUBE T9 C 22 EM V 11W 865 G10Q	4099854042485	■	22	G10q	212	11.0	1320	120	6500	≥80	110	30000		7
LED TUBE T9 C 32 EM V 18.3W 830 G10Q	4099854042508	■	32	G10q	300	18.3	2000	109	3000	≥80	110	30000		8
LED TUBE T9 C 32 EM V 18.3W 840 G10Q	4099854042522	■	32	G10q	300	18.3	2200	120	4000	≥80	110	30000		8
LED TUBE T9 C 32 EM V 18.3W 865 G10Q	4099854042546	■	32	G10q	300	18.3	2200	120	6500	≥80	110	30000		8
LED TUBE T9 C 40 EM V 24W 840 G10Q	4099854042560	■	40	G10q	400	24.0	2900	120	4000	≥80	110	30000		9
LED TUBE T9 C 40 EM V 24W 865 G10Q	4099854042584	■	40	G10q	400	24.0	2900	120	6500	≥80	110	30000		9

■ SUPERIOR CLASS ■ PERFORMANCE CLASS ■ VALUE CLASS

¹ LED tubes: L70/B50, LED DRIVER EXTERNAL: at Tc = 65 °C / 10% failure rate | ² Energy efficiency class (EEC) on a scale of A (highest efficiency) to G (lowest efficiency) | ³ Refer to www.ledvance.com/guarantee for precise conditions | ⁴ Check ECG compatibility at ledvance.com/compatibility or ledvance.com/tubefinder | ⁵ Designed to power with LEDVANCE LED DRIVER LED TUBE EXTERNAL DALI P | ⁶ Check dimmer compatibility at ledvance.com/compatibility | ⁷ Single sided LED TUBE (one-sided DC input) complying with safety requirement acc. IEC 62776:2014. Safety protection against electrical shock in misuse (ECG/CCG/Mains operation)



Check ECG compatibility at ledvance.com/compatibility or ledvance.com/tubefinder



REPLACE LAMP, KEEP HOUSING WITH LED TUBE EXTERNAL SYSTEM

DIMMABLE – REPLACEABLE – FIT FOR EMERGENCY LIGHTING

LEDVANCE makes your work switching to LED tubes even easier because now you can continue to use existing components, giving you a compelling answer to the challenges of your existing installation: our LED Tube External System consisting of an LED tube and external driver.

BENEFIT 1: HIGH EFFICIENCY

For converting old fluorescent lamp systems with dimmable DALI control to LED technology with optimal system efficiency, guaranteeing excellent performance with high energy savings and a long lifetime.

BENEFIT 2:

CIRCULAR ECONOMY

No compatibility problems thanks to an LED tube and driver system that fit, keeping the replaceable lighting components for greater economy and sustainability.

BENEFIT 3:

FIT FOR EMERGENCY LIGHTING

For upgrading emergency lighting systems with LED tubes.

SIMPLE INSTALLATION IN A FEW STEPS

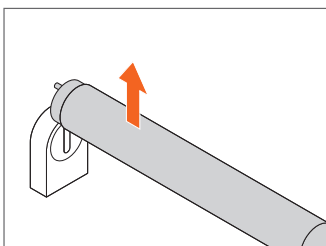

Remove the fluorescent tube from the base as usual.

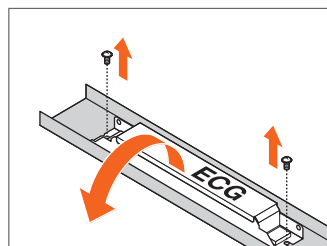

Release fastenings and remove ballast.

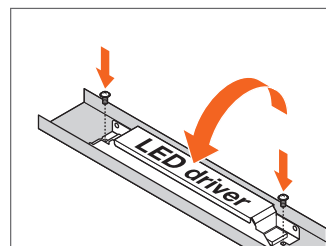

Insert, screw on and wire the same-size LED DRIVER EXTERNAL.

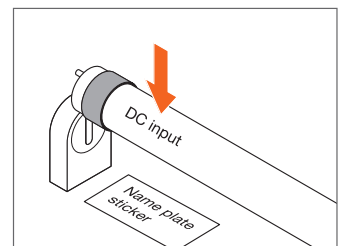

Insert the LED TUBE EXTERNAL on the active DC input side.

FEATURES LEDVANCE LED TUBE EXTERNAL SYSTEM



LED DRIVER EXTERNAL

- Multi-watt constant current SELV driver (1-channel and 2-channel version)
- High flexibility due to adjustable output currents via dip switch, fit for all T5 and T8 LED TUBE EXTERNAL
- DALI-2.0 interface for dimming and sensor operations
- Push DIM application for easy control
- Installation in emergency lighting systems according to IEC 61347-2-13, Appendix J
- ENEC mark
- Lifetime up to 100 000 h
- 5-year guarantee

LED DRIVER LED TUBE EXTERNAL DALI P

LED TUBE T8 EXTERNAL P



LED TUBE EXTERNAL

- Dimmable constant current LED tube
- Shatter protection thanks to special PET coating
- No bending thanks to glass tube
- Very high resistance to switching loads
- 3000K/4000K/6500K; 0.6m/0.9m/1.2m/1.5m
- Lifetime up to 50 000 h (1.2/1.5 m) and up to 75 000 h (0.6/0.9 m)
- 5-year guarantee
- Mercury-free and RoHS-compliant
- Linear lighting for industry, offices, warehouses and retail outlets

LED TUBE T5 EXTERNAL P

PERFORMANCE CLASS

HUGE SAVINGS AND QUICK PAYBACK

LED TUBE EXTERNAL SYSTEM

LED TUBE T8 EXT P 1500 mm 23W 840
 EAN: 4058075730557
 Driver: DR EXT DALI-P 1X7-37W 220-240
 EAN: 4099854295157



	OLD: Traditional T8 58W	NEW: LED TUBE T8 EXTERNAL SYSTEM	SAVINGS
Guarantee		5 years ¹	
Efficiency	90 lm/W	161 lm/W	
System wattage	58 W	23 W	
Average lifetime	15 000 h	50 000 h ²	
Energy consumption of project	6.8 kW	2.3 kW	
Energy consumption over period of operation	254 592 kWh	86 122 kWh	131 040 kWh
CO ₂ emissions (231 g/kWh) ³	58 811 kg	19 892 kg	30 270 kg
Total cost savings up to ⁴		50 %	
Payback time from		11 months	

TOTAL COST SAVINGS UP TO **50%**

COST SAVINGS FOR ELECTRICITY UP TO **60%**

PAYBACK TIME FROM **11** MONTHS

ENERGY SAVINGS UP TO **131 040** KWH

TOTAL CO₂ SAVINGS UP TO **60%**

! FURTHER ENERGY SAVINGS THROUGH THE USE OF SENSORS

GLOBAL PARAMETERS (example Warehouse): Period of operation: 60 months, 5 years, 37 440 operating hours | Operating times: 6 days per week, 52 weeks per year, 24 hours per day, dimming not included in calculation | Number of light points: 100 lamps, 50 luminaires

¹ Refer to www.ledvance.com/guarantee for precise conditions | ² Lifetime: LED TUBE T8 EXTERNAL P 50 000 h, t[h]: L70/B50 at 25 °C (T_a), LED DRIVER LED TUBE EXTERNAL DALI P 100 000 h, T_c: 65 °C; 10 % failure rate

³ 2020 European level of GHG emission intensity of electricity generation (www.eea.europa.eu) | ⁴ Calculation Parameters: Replacement costs: Traditional T8 58W 4.10 €/piece, LED TUBE T8 EXT P 1500 mm 23W 840 26.30 €/piece, DR EXT DALI-P-1X7-37W 220-240 71.97 €/piece, costs for exchanging: retrofit lamp 10.00 €/housing, conversion LED Tube External System 15.00 €/housing, electricity costs: 0.40 €/kWh. *Illustrative pricing. Prices may vary in your country.

INSTALLATION VIDEO:



For more information go to:
<https://youtu.be/9lhWFJeydEU>



FIND OUT MORE:



For more information go to:
ledvance.com/ext-system

LINEAR LED LUMINAIRES: UPGRADE OR NEW INSTALLATION?

SOLUTIONS WITH LED LUMINAIRES

UPGRADE



- if an existing luminaire needs to be kept but electric or mechanical interfaces are too old for a retrofit or conversion.

NEW INSTALLATION



- if the existing housing or other components have reached the end of their life
- if aesthetical or functional design requirements have changed
- if lighting performance requirements have changed, e.g. with regard to light distribution or quality
- if a light management system needs to be integrated, or there's an upgrade to human centric lighting

INCREASED PRODUCTIVITY



A new installation allows for the quality, distribution and function of the lighting to be perfectly adapted to current expectations, helping improve productivity.

It's preferable to an upgrade if keeping existing luminaires isn't important.

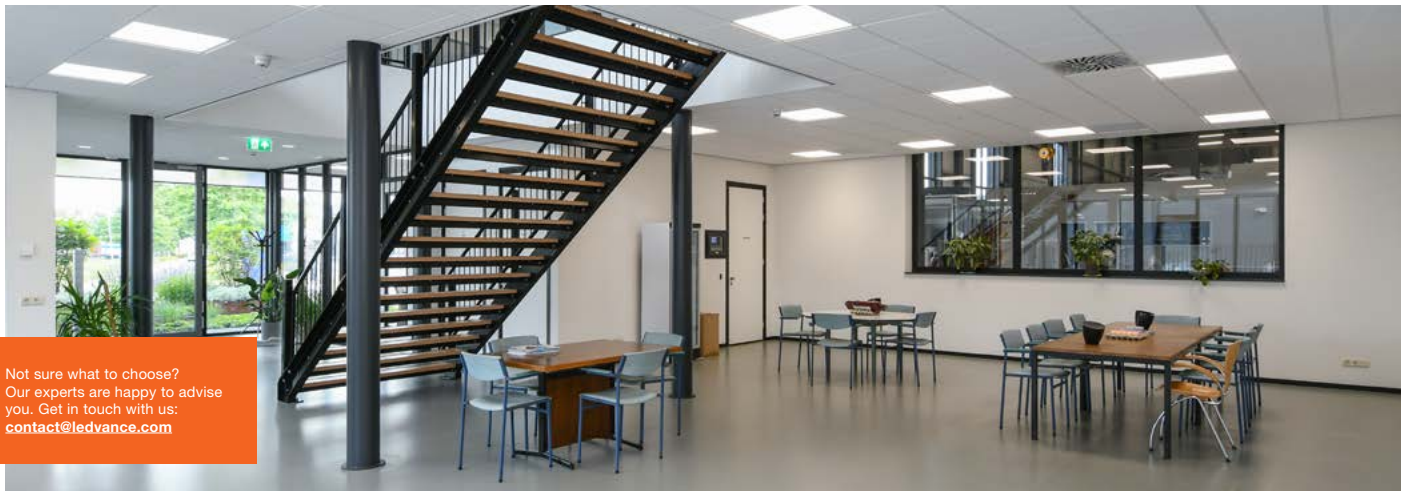

Not sure what to choose? Our experts are happy to advise you. Get in touch with us: contact@ledvance.com

RECOMMENDED PRODUCTS

	INDUSTRY Typical operating time: 24 h/day 6 days/week Recommended illuminance: 200 – 500+ lux	WAREHOUSE Typical operating time: 24 h/day 6 days/week Recommended illuminance: 200 – 300 lux	PARKING Typical operating time: 24 h/day 7 days/week Recommended illuminance: 75 – 300 lux	OFFICE/PUBLIC BUILDINGS Typical operating time: 14 h/day 5 days/week Recommended illuminance: 500+ lux
PANEL				
Panel Flex				✓
Panel Protect	✓	✓		✓
Panel Comfort				✓
DAMP PROOF				
Damp Proof Compact Gen 2	✓	✓	✓	✓
Damp Proof Gen 2	✓	✓	✓	✓
Damp Proof Special Gen 2	✓	✓	✓	
LINEAR				
Linear IndividLED				✓
Linear Surface IP44 Gen 2				✓
Linear Ultra Output Gen 2	✓	✓		✓
Linear Compact High Output				✓
Low Bay Flex Ball Proof	✓	✓		
Linear Magnetic Batten T5	✓	✓		✓

PRODUCT HIGHLIGHTS



Focussing on sustainability and the circular economy, this EVERLOOP luminaire offers a convenient replacement of light sources and LED drivers, making it ideal for office and education applications.

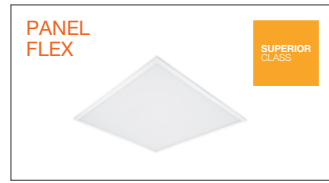

Office luminaire with high lumen output and multi lumen, economical high efficiency, up to 170lm/W and long lifetime. Additional versions with DALI-2 or for emergency installations available.

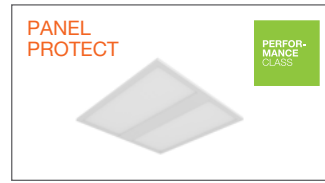

The tough panel luminaire: IP54 protection and resistant PMMA surface, ON/OFF or DALI versions (dimnable).



Highly efficient square or rectangular recessed panels offering multi lumen and multi colour function, low-glare, CRI90, ON/OFF or DALI IoT/Zigbee (dimnable) & EM conversion box compatibility.



Modern damp-proof luminaires with through-wired versions, highly versatile due to available multi lumen versions that allow 2 different lumen packages.



Damp-proof luminaires for a wide range of applications: ON/OFF switchable, DALI, through-wired and Emergency versions available.



Tubular damp-proof luminaire with extra high IP67 rating, pre-installed through-wiring, ammonium-resistant and for outdoor, industry and agricultural applications.



Robust IP44 luminaires with direct light emission, integrated driver for surface mounting, up to 137 lm/W. DALI and self-contained emergency versions also available.



Surface luminaire with high lumen output and very high luminous efficacy. Robust structure with IK08, through-wiring possible and easy time-saving installation. Multi lumen and multi colour function.



Compact single or light line luminaire with high luminous flux. Fast and seamless connection of up to 10 luminaires possible and low-flicker light thanks to special control gear.



Robust IK08 low-bay luminaires with attractive linear design, up to 160 lm/W, DALI Version available, pre-fitted with through-wiring cable and easy time-saving installation.



Luminaire-insert for upgrading existing metallic ceiling luminaires (T8 and T5 fluorescent) to energy-saving LED T5 technology. Available in 4 lengths.

You can find details and versions of the listed products or other luminaires at ledvance.com/luminaires



RETAIL Typical operating time: 15 h/day 7 days/week Recommended illuminance: 500+ lux	KEEPING FARM ANIMALS AND FOOD INDUSTRY	RESIDENTIAL AREAS Typical operating time: 2.7 h/day 7 days/week Recommended illuminance: 100+ lux	OUTDOOR AREAS / PUBLIC TRANSPORTATION Typical operating time: 10 h/day 7 days/week Recommended illuminance: 5 – 500+ lux	PUBLIC BUILDINGS / SPORTS AND LEISURE Typical operating time: 15 h/day 7 days/week Recommended illuminance: 100 – 500+ lux
		✓		
✓		✓		
		✓		
	✓	✓		
		✓	✓	
✓		✓		
				✓

DULUX LED LAMPS SOLUTIONS FOR ALL SITUATIONS

LED SOLUTIONS LEDVANCE DULUX LED LAMPS

RETROFIT



Simple 1:1 replacement
For existing installations

LEDVANCE DULUX LED lamp
Compatible with EM (CCG ballast or compatible ECG)

CONVERSION



Technical modification or rewiring
For existing luminaires

LEDVANCE DULUX LED lamp (case: no compatible ECG). If there is no retrofit alternative or if the customer values maximum energy savings and low maintenance, rewiring is the solution.
▶ All DULUX LED lamps can be converted to 230 V.

LED SOLUTIONS LEDVANCE LUMINAIRES

NEW INSTALLATION



Complete replacement with modern LED luminaires
New LED luminaires

- Wide range of innovative luminaires for new construction or refurbishment projects
- With high functionality for intelligent light control
- With long service life and maximum energy-saving potential

DULUX LED S EM & AC MAINS V G23



DULUX LED T/E HF & AC MAINS V GX24Q



DULUX LED D EM & AC MAINS V G24D

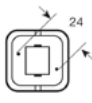

DULUX LED L HF & AC MAINS V 2G11

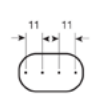

DULUX LED D/E HF & AC MAINS V G24Q

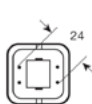

DULUX LED F EM & AC MAINS V 2G10



DULUX LED T EM & AC MAINS V GX24D

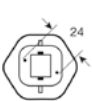

DULUX LED SQ EM & AC MAINS V GR8

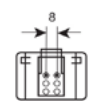

DOWNLIGHT COMFORT



DOWNLIGHT UGR 19



DOWNLIGHT ALU



SURFACE BULKHEAD



How to convert your DULUX LED Lamp to 230 V:
please find more information in the installation guide
ledvance.com/services



Check ECG compatibility at
ledvance.com/compatibility

DULUX LED LAMPS



wΔW Power in W for conventional technology

Product name GTIN (EAN) Segmentation **W** **lm** **K** **CRI** **t_{in}**¹ ²

DULUX LED D EM & AC MAINS V – LED replacement for CFLni with 2-pin G24d base for CCG and AC mains operation.

Product name	GTIN (EAN)	Segmentation	wΔW	E	I [mm]	Ø d [mm]	W	lm	K	CRI	A	t _{in}	IP	No.
DULUX LED D10 EM & AC MAINS V 5W 830 G24D-1	4058075823051	■	10	G24d-1	110.0	35.0	5.0	540	3000	80	120	30000	IP20	3
DULUX LED D10 EM & AC MAINS V 5W 840 G24D-1	4058075823075	■	10	G24d-1	110.0	35.0	5.0	600	4000	80	120	30000	IP20	3
DULUX LED D13 EM & AC MAINS V 6W 830 G24D-1	4058075823099	■	13	G24d-1	148.0	35.0	6.0	600	3000	80	120	30000	IP20	3
DULUX LED D13 EM & AC MAINS V 6W 840 G24D-1	4058075823112	■	13	G24d-1	148.0	35.0	6.0	660	4000	80	120	30000	IP20	3
DULUX LED D18 EM & AC MAINS V 7W 830 G24D-2	4058075823136	■	18	G24d-2	148.0	35.0	7.0	700	3000	80	120	30000	IP20	3
DULUX LED D18 EM & AC MAINS V 7W 840 G24D-2	4058075823150	■	18	G24d-2	148.0	35.0	7.0	770	4000	80	120	30000	IP20	3
DULUX LED D26 EM & AC MAINS V 9W 830 G24D-3	4058075823174	■	26	G24d-3	171.0	35.0	9.0	990	3000	80	120	30000	IP20	3
DULUX LED D26 EM & AC MAINS V 9W 840 G24D-3	4058075823198	■	26	G24d-3	171.0	35.0	9.0	1100	4000	80	120	30000	IP20	3

DULUX LED D VT EM & AC MAINS V – LED replacement for CFLni with 2-pin G24d base for CCG and AC mains operation.

Product name	GTIN (EAN)	Segmentation	wΔW	E	I [mm]	Ø d [mm]	W	lm	K	CRI	A	t _{in}	IP	No.
DULUX LED D13 VT EM & AC MAINS V 5.5W 830 G24D	4058075821811	■	13	G24d	103.0	37.7	5.5	640	3000	80	300	30000	IP20	3
DULUX LED D13 VT EM & AC MAINS V 5.5W 840 G24D	4058075821835	■	13	G24d	103.0	37.7	5.5	700	4000	80	300	30000	IP20	3
DULUX LED D18 VT EM & AC MAINS V 7.5W 830 G24D	4058075821859	■	18	G24d	117.0	37.7	7.5	870	3000	80	300	30000	IP20	3
DULUX LED D18 VT EM & AC MAINS V 7.5W 840 G24D	4058075821873	■	18	G24d	117.0	37.7	7.5	950	4000	80	300	30000	IP20	3
DULUX LED D26 VT EM & AC MAINS V 9.5W 830 G24D	4058075821897	■	26	G24d	125.5	37.7	9.5	1080	3000	80	300	30000	IP20	3
DULUX LED D26 VT EM & AC MAINS V 9.5W 840 G24D	4058075821910	■	26	G24d	125.5	37.7	9.5	1200	4000	80	300	30000	IP20	3

DULUX LED D/E HF & AC MAINS V – LED replacement for CFLni, with 4-pin G24q base for CCG and AC mains operation

Product name	GTIN (EAN)	Segmentation	wΔW	E	I [mm]	Ø d [mm]	W	lm	K	CRI	A	t _{in}	IP	No.
DULUX LED D/E13 HF & AC MAINS V 6W 830 G24Q-1	4058075821934	■	13	G24q-1	142.8	33.0	6.0	600	3000	80	120	30000	IP20	3
DULUX LED D/E13 HF & AC MAINS V 6W 840 G24Q-1	4058075821958	■	13	G24q-1	142.8	33.0	6.0	660	4000	80	120	30000	IP20	3
DULUX LED D/E18 HF & AC MAINS V 7W 830 G24Q-2	4058075821972	■	18	G24q-2	142.8	33.0	7.0	700	3000	80	120	30000	IP20	3
DULUX LED D/E18 HF & AC MAINS V 7W 840 G24Q-2	4058075821996	■	18	G24q-2	142.8	33.0	7.0	770	4000	80	120	30000	IP20	3
DULUX LED D/E26 HF & AC MAINS V 10W 830 G24Q-3	4058075822016	■	26	G24q-3	169.8	33.0	10.0	990	3000	80	120	30000	IP20	3
DULUX LED D/E26 HF & AC MAINS V 10W 840 G24Q-3	4058075822030	■	26	G24q-3	169.8	33.0	10.0	1100	4000	80	120	30000	IP20	3

DULUX LED S EM & AC MAINS V – LED replacement for short CFLni, with 2-pin G23 base for CCG and AC mains operation.

Product name	GTIN (EAN)	Segmentation	wΔW	E	I [mm]	Ø d [mm]	W	lm	K	CRI	A	t _{in}	IP	No.
DULUX LED S7 EM & AC MAINS V 3.5W 830 G23	4058075822931	■	7	G23	135.0	32.3	3.5	360	3000	80	120	30000	IP20	3
DULUX LED S7 EM & AC MAINS V 3.5W 840 G23	4058075822955	■	7	G23	135.0	32.3	3.5	400	4000	80	120	30000	IP20	3
DULUX LED S9 EM & AC MAINS V 4W 830 G23	4058075822979	■	9	G23	165.0	32.3	4.0	500	3000	80	120	30000	IP20	3
DULUX LED S9 EM & AC MAINS V 4W 840 G23	4058075822993	■	9	G23	165.0	32.3	4.0	550	4000	80	120	30000	IP20	3
DULUX LED S11 EM & AC MAINS V 6W 830 G23	4058075823013	■	11	G23	220.0	32.3	6.0	630	3000	80	120	30000	IP20	3
DULUX LED S11 EM & AC MAINS V 6W 840 G23	4058075823037	■	11	G23	220.0	32.3	6.0	700	4000	80	120	30000	IP20	3

DULUX LED L HF & AC MAINS V – LED replacement for CFLni, with 4-pin 2G11 base for CCG and AC mains operation

Product name	GTIN (EAN)	Segmentation	wΔW	E	I [mm]	Ø d [mm]	W	lm	K	CRI	A	t _{in}	IP	No.
DULUX LED L18 HF & AC MAINS V 8W 830 2G11	4058075822054	■	18	2G11	229.5	44.0	8.0	900	3000	80	140	30000	IP20	3
DULUX LED L18 HF & AC MAINS V 8W 840 2G11	4058075822078	■	18	2G11	229.5	44.0	8.0	1000	4000	80	140	30000	IP20	3
DULUX LED L24 HF & AC MAINS V 12W 830 2G11	4058075822092	■	24	2G11	324.5	44.0	12.0	1350	3000	80	140	30000	IP20	3
DULUX LED L24 HF & AC MAINS V 12W 840 2G11	4058075822115	■	24	2G11	324.5	44.0	12.0	1500	4000	80	140	30000	IP20	3
DULUX LED L36 HF & AC MAINS V 18W 830 2G11	4058075822139	■	36	2G11	416.5	44.0	18.0	2070	3000	80	140	30000	IP20	3
DULUX LED L36 HF & AC MAINS V 18W 840 2G11	4058075822153	■	36	2G11	416.5	44.0	18.0	2300	4000	80	140	30000	IP20	3
DULUX LED L55 HF & AC MAINS V 25W 830 2G11	4058075822177	■	55	2G11	537.0	44.0	25.0	2950	3000	80	140	30000	IP20	3
DULUX LED L55 HF & AC MAINS V 25W 840 2G11	4058075822191	■	55	2G11	537.0	44.0	25.0	3250	4000	80	140	30000	IP20	3

SAFETY ADVICE: The operating temperature range of DULUX LED is restricted. In case of doubt regarding suitability of the application please measure T_c max temperature on the product prior to installation.



Check ECG compatibility at ledvance.com/compatibility

■ SUPERIOR CLASS ■ PERFORMANCE CLASS ■ VALUE CLASS

¹ L70/B50 | ² Energy efficiency class (EEC) on a scale of A (highest efficiency) to G (lowest efficiency) | ³ Refer to www.ledvance.com/guarantee for precise conditions | ⁴ Compatibility list also online: ledvance.com/compatibility

DULUX LED LAMPS



wΔW Power in W for conventional technology

Product name	GTIN (EAN)	Segmentation	wΔW		I [mm]	\varnothing d [mm]	W	lm	K	CRI	t_{in} ¹		
--------------	------------	--------------	-----	--	-------------	----------------------------	---	----	---	-----	-----------------------	--	--

DULUX LED F EM & AC MAINS V – LED replacement for flat CFLni with 4-pin 2G10 base for CCG and AC mains operation.

Product name	GTIN (EAN)	Segmentation	wΔW		I [mm]	\varnothing d [mm]	W	lm	K	CRI	t_{in} ¹		
DULUX LED F18 EM & AC MAINS V 8W 830 2G10	4058075822412	■	18	2G10	128.0	89.5	8.0	900	3000	80	130	30000	
DULUX LED F18 EM & AC MAINS V 8W 840 2G10	4058075822436	■	18	2G10	128.0	89.5	8.0	1000	4000	80	130	30000	
DULUX LED F24 EM & AC MAINS V 12W 830 2G10	4058075822450	■	24	2G10	169.5	89.5	12.0	1350	3000	80	130	30000	
DULUX LED F24 EM & AC MAINS V 12W 840 2G10	4058075822474	■	24	2G10	169.5	89.5	12.0	1500	4000	80	130	30000	
DULUX LED F36 EM & AC MAINS V 20W 830 2G10	4058075822498	■	36	2G10	221.5	89.5	20.0	2250	3000	80	130	30000	
DULUX LED F36 EM & AC MAINS V 20W 840 2G10	4058075822511	■	36	2G10	221.5	89.5	20.0	2500	4000	80	130	30000	

DULUX LED T EM & AC MAINS V – LED replacement for CFLni with 2-pin GX24d base for CCG and AC mains operation.

Product name	GTIN (EAN)	Segmentation	wΔW		I [mm]	\varnothing d [mm]	W	lm	K	CRI	t_{in} ¹		
DULUX LED T13 EM & AC MAINS V 6W 830 GX24d-1	4058075823211	■	13	GX24d-1	132.0	38.0	6.0	630	3000	80	120	30000	
DULUX LED T13 EM & AC MAINS V 6W 840 GX24d-1	4058075823235	■	13	GX24d-1	132.0	38.0	6.0	700	4000	80	120	30000	
DULUX LED T18 EM & AC MAINS V 7W 830 GX24d-2	4058075823259	■	18	GX24d-2	132.0	38.0	7.0	720	3000	80	120	30000	
DULUX LED T18 EM & AC MAINS V 7W 840 GX24d-2	4058075823273	■	18	GX24d-2	132.0	38.0	7.0	800	4000	80	120	30000	
DULUX LED T26 EM & AC MAINS V 9W 830 GX24d-3	4058075823297	■	26	GX24d-3	147.0	38.0	9.0	1000	3000	80	120	30000	
DULUX LED T26 EM & AC MAINS V 9W 840 GX24d-3	4058075823310	■	26	GX24d-3	147.0	38.0	9.0	1100	4000	80	120	30000	

DULUX LED T/E HF & AC MAINS V – LED replacement for CFLni with 4-pin GX24q base for CCG and AC mains operation

Product name	GTIN (EAN)	Segmentation	wΔW		I [mm]	\varnothing d [mm]	W	lm	K	CRI	t_{in} ¹		
DULUX LED T/E13 HF & AC MAINS V 6W 830 GX24q-1	4058075822214	■	13	GX24q-1	102.8	45.0	6.0	630	3000	80	120	30000	
DULUX LED T/E13 HF & AC MAINS V 6W 840 GX24q-1	4058075822238	■	13	GX24q-1	102.8	45.0	6.0	700	4000	80	120	30000	
DULUX LED T/E18 HF & AC MAINS V 7W 830 GX24q-2	4058075822252	■	18	GX24q-2	119.8	45.0	7.0	720	3000	80	120	30000	
DULUX LED T/E18 HF & AC MAINS V 7W 840 GX24q-2	4058075822276	■	18	GX24q-2	119.8	45.0	7.0	800	4000	80	120	30000	
DULUX LED T/E26 HF & AC MAINS V 10W 830 GX24q-3	4058075822290	■	26	GX24q-3	139.8	45.0	10.0	990	3000	80	120	30000	
DULUX LED T/E26 HF & AC MAINS V 10W 840 GX24q-3	4058075822313	■	26	GX24q-3	139.8	45.0	10.0	1100	4000	80	120	30000	
DULUX LED T/E32 HF & AC MAINS V 16W 830 GX24q-3	4058075822337	■	32	GX24q-3	154.8	45.0	16.0	1620	3000	80	120	30000	
DULUX LED T/E32 HF & AC MAINS V 16W 840 GX24q-3	4058075822351	■	32	GX24q-3	154.8	45.0	16.0	1800	4000	80	120	30000	
DULUX LED T/E42 HF & AC MAINS V 20W 830 GX24q-4	4058075822375	■	42	GX24q-4	164.8	45.0	20.0	2025	3000	80	120	30000	
DULUX LED T/E42 HF & AC MAINS V 20W 840 GX24q-4	4058075822399	■	42	GX24q-4	164.8	45.0	20.0	2250	4000	80	120	30000	

DULUX LED SQ EM & AC MAINS V – LED replacement for CFLni with 2-pin GR8 base for CCG and AC mains operation.

Product name	GTIN (EAN)	Segmentation	wΔW		I [mm]	\varnothing d [mm]	W	lm	K	CRI	t_{in} ¹		
DULUX LED SQ16 EM & AC MAINS V 7W 830 GR8	4058075822535	■	16	GR8	137.1	134.0	7.0	720	3000	80	130	30000	
DULUX LED SQ16 EM & AC MAINS V 7W 835 GR8	4058075822559	■	16	GR8	137.1	134.0	7.0	720	3500	80	130	30000	
DULUX LED SQ28 EM & AC MAINS V 13W 830 GR8	4058075822573	■	28	GR8	204.0	202.0	13.0	1350	3000	80	130	30000	
DULUX LED SQ28 EM & AC MAINS V 13W 835 GR8	4058075822597	■	28	GR8	204.0	202.0	13.0	1350	3500	80	130	30000	

SAFETY ADVICE: The operating temperature range of DULUX LED is restricted. In case of doubt regarding suitability of the application please measure T_c max temperature on the product prior to installation.



Check ECG compatibility at ledvance.com/compatibility

■ SUPERIOR CLASS ■ PERFORMANCE CLASS ■ VALUE CLASS

¹ L70/B50 | ² Energy efficiency class (EEC) on a scale of A (highest efficiency) to G (lowest efficiency)

³ Refer to www.ledvance.com/guarantee for precise conditions | ⁴ Compatibility list also online: ledvance.com/compatibility

NEW LED LUMINAIRE INSTALLATION: SOLUTIONS WITH ADDED BENEFITS

NEW INSTALLATION WITH LED LUMINAIRES



By installing new LED luminaires, the lighting can be perfectly adapted to contemporary standards in terms of aesthetics, function and quality of light. Integrating them into a light management system or installing human centric lighting is also easy and convenient.

INCREASED PRODUCTIVITY



As a result, users benefit not only from outstanding energy efficiency but also from improved productivity thanks to ideal lighting conditions.

PRODUCT HIGHLIGHTS

DOWNLIGHT UGR19



PERFORMANCE CLASS

Downlights with good UGR < 19 glare reduction and up to 30° cut-off angle for comfortable lighting. IP54, low flicker, ON/OFF or IoT-ready DALI/Zigbee versions.

DOWNLIGHT COMFORT



PERFORMANCE CLASS

Downlights with multi colour adjustment, selectable on the luminaire. Aluminum housing, polycarbonate diffuser, good glare reduction, IP54 and easy wiring push terminals.

DOWNLIGHT ALU



VALUE CLASS

Downlight luminaires with aluminum housing. For dusty and humid environments thanks to IP44, DALI versions also available.

DOWNLIGHT SLIM ALU



VALUE CLASS

Flat downlights with external driver and aluminum housing. Extremely small mounting depth due to very low-profile housing.

SURFACE FLAT



PERFORMANCE CLASS



Round or square shaped luminaire in 330/500 mm with changeable light source and driver. Multi lumen and multi colour function, IP54, high system efficiency, IoT ready DALI-2 or sensor versions available.

SURFACE COMPACT IK10



PERFORMANCE CLASS

Wall and ceiling luminaire with high impact IK10 resistance. Vandalism resistant, IP65 protection, high luminous efficacy and through-wiring possible.

SURFACE BULKHEAD



PERFORMANCE CLASS



Robust IK10 and highly efficient indoor/outdoor luminaire with changeable light source and driver for public area use. Width 250 or 300 mm, in white or black, sensor, DALI and emergency versions available.

SURFACE CIRCULAR/SQUARE



VALUE CLASS

Wall and ceiling luminaires with IP44. Versions with sensor: easy adjustment sensor range, daylight detection and illumination time.

RECOMMENDED PRODUCTS

	OFFICE/PUBLIC BUILDINGS Typical operating time: 14 h/day 5 days/week Recommended illuminance: 500+ lux	RETAIL Typical operating time: 15 h/day 7 days/week Recommended illuminance: 500+ lux	RESIDENTIAL AREAS Typical operating time: 2.7 h/day 7 days/week Recommended illuminance: 100+ lux
DOWNLIGHTS			
Downlight UGR19	✓	✓	
Downlight Comfort	✓	✓	
Downlight Alu	✓	✓	
Downlight Slim Alu	✓	✓	✓
SURFACE			
Surface Flat	✓		✓
Surface Compact IK10	✓		✓
Surface Bulkhead	✓		✓
Surface Circular/Square	✓		✓



You can find details and versions of the listed products or other luminaires at ledvance.com/luminaires



Discover more about our new EVERLOOP luminaires at ledvance.com/everloop

Not sure what to choose? Our experts are happy to advise you. Get in touch with us: contact@ledvance.com

POSSIBLE LED ALTERNATIVES TO FLUORESCENT TUBES, COMPACT FLUORESCENT LAMPS AND HALOGEN PINS

In the tables below you can see what LED alternatives are available to replace the conventional light sources that are being withdrawn from the market. There are some important criteria to consider. LED light sources do not have the same output as their conventional counterparts – their beam angles are not identical. Therefore, we recommend that you carry out application-specific lighting design before any installation to ensure that the lighting level is the same after the replacement.

Light sources affected by the lamp ban	Possible LED alternatives
--	---------------------------

Linear fluorescent lamps – T8



LED TUBE T8 Universal P



Conventional lamp	EAN (GTIN)	LED alternative	Ballast	Note to the proposed alternative
L 18 W/827	4099854026119	LED TUBE T8 UNIVERSAL P 600 mm 7.5W 830	ECG ¹ / CCG / AC Mains	Color temperature 3 000 K
L 18 W/830	4099854026119	LED TUBE T8 UNIVERSAL P 600 mm 7.5W 830	ECG ¹ / CCG / AC Mains	
L 18 W/840	4099854026157	LED TUBE T8 UNIVERSAL P 600 mm 7.5W 840	ECG ¹ / CCG / AC Mains	
L 18 W/865	4099854026218	LED TUBE T8 UNIVERSAL P 600 mm 7.5W 865	ECG ¹ / CCG / AC Mains	
L 18 W/880	4099854026218	LED TUBE T8 UNIVERSAL P 600 mm 7.5W 865	ECG ¹ / CCG / AC Mains	Color temperature 6 500 K
L 36 W/827	—	—	—	—
L 36 W/830	4099854026294	LED TUBE T8 UNIVERSAL ULTRA OUTPUT P 1200 mm 15W 840	ECG ¹ / CCG / AC Mains	Color temperature 4 000 K
L 36 W/840	4099854026294	LED TUBE T8 UNIVERSAL ULTRA OUTPUT P 1200 mm 15W 840	ECG ¹ / CCG / AC Mains	
L 36 W/865	4099854026331	LED TUBE T8 UNIVERSAL ULTRA OUTPUT P 1200 mm 15W 865	ECG ¹ / CCG / AC Mains	
L 36 W/880	4099854026331	LED TUBE T8 UNIVERSAL ULTRA OUTPUT P 1200 mm 15W 865	ECG ¹ / CCG / AC Mains	Color temperature 6 500 K
L 58 W/827	—	—	—	—
L 58 W/830	4099854026577	LED TUBE T8 UNIVERSAL ULTRA OUTPUT P 1500 mm 23W 840	ECG ¹ / CCG / AC Mains	Color temperature 4 000 K
L 58 W/840	4099854026577	LED TUBE T8 UNIVERSAL ULTRA OUTPUT P 1500 mm 23W 840	ECG ¹ / CCG / AC Mains	
L 58 W/865	4099854026591	LED TUBE T8 UNIVERSAL ULTRA OUTPUT P 1500 mm 23W 865	ECG ¹ / CCG / AC Mains	
L 58 W/880	4099854026591	LED TUBE T8 UNIVERSAL ULTRA OUTPUT P 1500 mm 23W 865	ECG ¹ / CCG / AC Mains	Color temperature 6 500 K

Linear fluorescent lamps – T8



LED TUBE T8 EM V



Conventional lamp	EAN (GTIN)	LED alternative	Ballast	Note to the proposed alternative
L 18 W/827	4099854038969	LED TUBE T8 EM V 600 mm 6.6W 830	CCG	Color temperature 3 000 K
L 18 W/830	4099854038969	LED TUBE T8 EM V 600 mm 6.6W 830	CCG	
L 18 W/840	4099854037412	LED TUBE T8 EM S 600 mm 6.3W 840	CCG	
L 18 W/865	4099854037436	LED TUBE T8 EM S 600 mm 6.3W 865	CCG	
L 18 W/880	4099854037436	LED TUBE T8 EM S 600 mm 6.3W 865	CCG	Color temperature 6 500 K
L 36 W/827	4099854037092	LED TUBE T8 EM ULTRA OUTPUT S 1200 mm 14W 830	CCG	Color temperature 3 000 K
L 36 W/830	4099854037092	LED TUBE T8 EM ULTRA OUTPUT S 1200 mm 14W 830	CCG	
L 36 W/840	4099854037115	LED TUBE T8 EM ULTRA OUTPUT S 1200 mm 14W 840	CCG	
L 36 W/865	4099854037191	LED TUBE T8 EM ULTRA OUTPUT S 1200 mm 14W 865	CCG	
L 36 W/880	4099854037191	LED TUBE T8 EM ULTRA OUTPUT S 1200 mm 14W 865	CCG	Color temperature 6 500 K
L 58 W/827	4099854037214	LED TUBE T8 EM ULTRA OUTPUT S 1500 mm 22.2W 830	CCG	Color temperature 3 000 K
L 58 W/830	4099854037214	LED TUBE T8 EM ULTRA OUTPUT S 1500 mm 22.2W 830	CCG	
L 58 W/840	4099854037238	LED TUBE T8 EM ULTRA OUTPUT S 1500 mm 22.1W 840	CCG	
L 58 W/865	4099854037276	LED TUBE T8 EM ULTRA OUTPUT S 1500 mm 22.1W 865	CCG	
L 58 W/880	4099854037276	LED TUBE T8 EM ULTRA OUTPUT S 1500 mm 22.1W 865	CCG	Color temperature 6 500 K

This is just a small selection of LED alternatives from our extensive range of lamps. For more LED alternatives please visit ledvance.com/lampfinder



¹Check ECG compatibility at ledvance.com/compatibility or ledvance.com/tubefinder

Light sources affected by the lamp ban **Possible LED alternatives**

Linear fluorescent lamps – T5 HE

LED TUBE T5 HF HE



Conventional lamp	EAN (GTIN)	LED alternative	Ballast	Note to the proposed alternative
HE 14 W/827	4099854029448	LED TUBE T5 HF HE14 P 549 mm 7W 830	ECG ¹	Color temperature 3 000 K
HE 14 W/830	4099854029448	LED TUBE T5 HF HE14 P 549 mm 7W 830	ECG ¹	
HE 14 W/840	4099854029462	LED TUBE T5 HF HE14 P 549 mm 7W 840	ECG ¹	
HE 14 W/865	4099854029486	LED TUBE T5 HF HE14 P 549 mm 7W 865	ECG ¹	
HE 21 W/827	4099854029387	LED TUBE T5 HF HE21 P 849 mm 10W 830	ECG ¹	Color temperature 3 000 K
HE 21 W/830	4099854029387	LED TUBE T5 HF HE21 P 849 mm 10W 830	ECG ¹	
HE 21 W/840	4099854029400	LED TUBE T5 HF HE21 P 849 mm 10W 840	ECG ¹	
HE 21 W/865	4099854029424	LED TUBE T5 HF HE21 P 849 mm 10W 865	ECG ¹	
HE 28 W/827	4099854029325	LED TUBE T5 HF HE28 P 1149 mm 16W 830	ECG ¹	Color temperature 3 000 K
HE 28 W/830	4099854029325	LED TUBE T5 HF HE28 P 1149 mm 16W 830	ECG ¹	
HE 28 W/840	4099854029349	LED TUBE T5 HF HE28 P 1149 mm 16W 840	ECG ¹	
HE 28 W/865	4099854029363	LED TUBE T5 HF HE28 P 1149 mm 16W 865	ECG ¹	
HE 35 W/827	4099854029172	LED TUBE T5 HF HE35 P 1449 mm 18W 830	ECG ¹	Color temperature 3 000 K
HE 35 W/830	4099854029172	LED TUBE T5 HF HE35 P 1449 mm 18W 830	ECG ¹	
HE 35 W/840	4099854029196	LED TUBE T5 HF HE35 P 1449 mm 18W 840	ECG ¹	
HE 35 W/865	4099854029219	LED TUBE T5 HF HE35 P 1449 mm 18W 865	ECG ¹	

Linear fluorescent lamps – T5 HO

LED TUBE T5 AC/HF HO



Conventional lamp	EAN (GTIN)	LED alternative	Ballast	Note to the proposed alternative
HO 24 W/827	4099854081200	LED TUBE T5 AC HO24 P 549 mm 10W 830	AC Mains	Color temperature 3 000 K
HO 24 W/830	4099854081200	LED TUBE T5 AC HO24 P 549 mm 10W 830	AC Mains	
HO 24 W/840	4099854081224	LED TUBE T5 AC HO24 P 549 mm 10W 840	AC Mains	
HO 24 W/865	4099854081248	LED TUBE T5 AC HO24 P 549 mm 10W 865	AC Mains	
HO 39 W/830	4099854081149	LED TUBE T5 AC HO39 P 849 mm 16W 830	AC Mains	
HO 39 W/840	4099854081163	LED TUBE T5 AC HO39 P 849 mm 16W 840	AC Mains	
HO 39 W/865	4099854081187	LED TUBE T5 AC HO39 P 849 mm 16W 865	AC Mains	
HO 49 W/827	4099854029110	LED TUBE T5 HF HO49 P 1449 mm 26W 830	ECG ¹	Color temperature 3 000 K
HO 49 W/830	4099854029110	LED TUBE T5 HF HO49 P 1449 mm 26W 830	ECG ¹	
HO 49 W/840	4099854029134	LED TUBE T5 HF HO49 P 1449 mm 26W 840	ECG ¹	
HO 49 W/865	4099854029158	LED TUBE T5 HF HO49 P 1449 mm 26W 865	ECG ¹	
HO 54 W/827	4099854029257	LED TUBE T5 HF HO54 P 1149 mm 26W 830	ECG ¹	Color temperature 3 000 K
HO 54 W/830	4099854029257	LED TUBE T5 HF HO54 P 1149 mm 26W 830	ECG ¹	
HO 54 W/840	4099854029271	LED TUBE T5 HF HO54 P 1149 mm 26W 840	ECG ¹	
HO 54 W/865	4099854029301	LED TUBE T5 HF HO54 P 1149 mm 26W 865	ECG ¹	
HO 80 W/830	4099854029059	LED TUBE T5 HF HO80 P 1449 mm 36W 830	ECG ¹	
HO 80 W/840	4099854029073	LED TUBE T5 HF HO80 P 1449 mm 36W 840	ECG ¹	
HO 80 W/865	4099854029097	LED TUBE T5 HF HO80 P 1449 mm 36W 865	ECG ¹	

Linear fluorescent lamps – T5 DE LUXE HO

LED TUBE T5 AC/HF HO



Conventional lamp	EAN (GTIN)	LED alternative	Ballast	Note to the proposed alternative
HO 24 W/940	4099854081224	LED TUBE T5 AC HO24 P 549 mm 10W 840	AC Mains	CRI > 80
HO 24 W/965	4099854081248	LED TUBE T5 AC HO24 P 549 mm 10W 865	AC Mains	CRI > 80
HO 49 W/940	4099854029134	LED TUBE T5 HF HO49 P 1449 mm 26W 840	ECG ¹	CRI > 80
HO 49 W/965	4099854029158	LED TUBE T5 HF HO49 P 1449 mm 26W 865	ECG ¹	CRI > 80
HO 54 W/940	4099854029271	LED TUBE T5 HF HO54 P 1149 mm 26W 840	ECG ¹	CRI > 80
HO 54 W/965	4099854029301	LED TUBE T5 HF HO54 P 1149 mm 26W 865	ECG ¹	CRI > 80

This is just a small selection of LED alternatives from our extensive range of lamps. For more LED alternatives please visit ledvance.com/lampfinder



¹Check ECG compatibility at ledvance.com/compatibility or ledvance.com/tubefinder

Light sources affected by the lamp ban	Possible LED alternatives
--	---------------------------

Compact fluorescent lamps - DULUX S, 2 Pins

DULUX LED S EM & AC MAINS V



Conventional lamp	EAN (GTIN)	LED alternative	Ballast	Note to the proposed alternative
DULUX S 5 W/827	—	LED luminaire solutions available. Large range of innovative LED luminaires for complete replacement at ledvance.com/luminaires	—	—
DULUX S 5 W/840	—	—	—	—
DULUX S 7 W/827	4058075822931	DULUX LED S7 EM & AC MAINS V 3.5W 830 G23	CCG / AC mains	Color temperature 3 000 K
DULUX S 7 W/830	4058075822931	DULUX LED S7 EM & AC MAINS V 3.5W 830 G23	CCG / AC mains	—
DULUX S 7 W/840	4058075822955	DULUX LED S7 EM & AC MAINS V 3.5W 840 G23	CCG / AC mains	—
DULUX S 9 W/827	4058075822979	DULUX LED S9 EM & AC MAINS V 4W 830 G23	CCG / AC mains	Color temperature 3 000 K
DULUX S 9 W/830	4058075822979	DULUX LED S9 EM & AC MAINS V 4W 830 G23	CCG / AC mains	—
DULUX S 9 W/840	4058075822993	DULUX LED S9 EM & AC MAINS V 4W 840 G23	CCG / AC mains	—
DULUX S 11 W/827	4058075823013	DULUX LED S11 EM & AC MAINS V 6W 830 G23	CCG / AC mains	Color temperature 3 000 K
DULUX S 11 W/830	4058075823013	DULUX LED S11 EM & AC MAINS V 6W 830 G23	CCG / AC mains	—
DULUX S 11 W/840	4058075823037	DULUX LED S11 EM & AC MAINS V 6W 840 G23	CCG / AC mains	—

Compact fluorescent lamps - DULUX S/E, 4 Pins



Conventional lamp	EAN (GTIN)	LED alternative	Ballast	Note to the proposed alternative
DULUX S/E 7 W/827	—	LED luminaire solutions available. Large range of innovative LED luminaires for complete replacement at ledvance.com/luminaires	—	—
DULUX S/E 7 W/830	—		—	—
DULUX S/E 7 W/840	—		—	—
DULUX S/E 9 W/827	—		—	—
DULUX S/E 9 W/830	—		—	—
DULUX S/E 9 W/840	—		—	—
DULUX S/E 11 W/827	—		—	—
DULUX S/E 11 W/830	—		—	—
DULUX S/E 11 W/840	—		—	—

Compact fluorescent lamps - DULUX D, 2 Pins

DULUX LED D EM & AC MAINS V



Conventional lamp	EAN (GTIN)	LED alternative	Ballast	Note to the proposed alternative
DULUX D 10 W/827	4058075823051	DULUX LED D10 EM & AC MAINS V 5W 830 G24D-1	CCG / AC mains	Color temperature 3 000 K
DULUX D 10 W/830	4058075823051	DULUX LED D10 EM & AC MAINS V 5W 830 G24D-1	CCG / AC mains	—
DULUX D 10 W/840	4058075823075	DULUX LED D10 EM & AC MAINS V 5W 840 G24D-1	CCG / AC mains	—
DULUX D 13 W/827	4058075823099	DULUX LED D13 EM & AC MAINS V 6W 830 G24D-1	CCG / AC mains	Color temperature 3 000 K
DULUX D 13 W/830	4058075823099	DULUX LED D13 EM & AC MAINS V 6W 830 G24D-1	CCG / AC mains	—
DULUX D 13 W/840	4058075823112	DULUX LED D13 EM & AC MAINS V 6W 840 G24D-1	CCG / AC mains	—
DULUX D 18 W/827	4058075823136	DULUX LED D18 EM & AC MAINS V 7W 830 G24D-2	CCG / AC mains	Color temperature 3 000 K
DULUX D 18 W/830	4058075823136	DULUX LED D18 EM & AC MAINS V 7W 830 G24D-2	CCG / AC mains	—
DULUX D 18 W/840	4058075823150	DULUX LED D18 EM & AC MAINS V 7W 840 G24D-2	CCG / AC mains	—
DULUX D 18 W/865	4058075823150	DULUX LED D18 EM & AC MAINS V 7W 840 G24D-2	CCG / AC mains	Color temperature 4 000 K
DULUX D 26 W/827	4058075823174	DULUX LED D26 EM & AC MAINS V 9W 830 G24D-3	CCG / AC mains	Color temperature 3 000 K
DULUX D 26 W/830	4058075823174	DULUX LED D26 EM & AC MAINS V 9W 830 G24D-3	CCG / AC mains	—
DULUX D 26 W/840	4058075823198	DULUX LED D26 EM & AC MAINS V 9W 840 G24D-3	CCG / AC mains	—
DULUX D 26 W/865	4058075823198	DULUX LED D26 EM & AC MAINS V 9W 840 G24D-3	CCG / AC mains	Color temperature 4 000 K

NOT SURE WHAT TO CHOOSE?

LEDVANCE takes care of tailor-made calculations and offers you a customized solution for your lighting requirements – all from a single source. Please get in touch. We look forward to hearing from you.

Email: contact@ledvance.com | **Phone:** +49 89 780673-660

YOUR BENEFITS AT A GLANCE

- Uniformly good light distribution
- Precise wattage per sqm
- Maximum efficient calculation of required number of luminaires and VIVARES components

This is just a small selection of LED alternatives from our extensive range of lamps. For more LED alternatives please visit ledvance.com/lampfinder



Light sources affected by the lamp ban Possible LED alternatives

Compact fluorescent lamps - Dulux D/E, 4 Pins

DULUX LED D/E HF & AC MAINS V



Conventional lamp	EAN (GTIN)	LED alternative	Ballast	Note to the proposed alternative
DULUX D/E 10 W/827	---	LED luminaire solutions available. Large range of innovative LED luminaires for complete replacement at ledvance.com/luminaires	ECG ¹ /AC Mains	Color temperature 3000K
DULUX D/E 10 W/830	---		ECG ¹ /AC Mains	
DULUX D/E 10 W/840	---		ECG ¹ /AC Mains	
DULUX D/E 13 W/827	4058075821934	DULUX LED D/E13 HF & AC MAINS V 6W 830 G24Q-1	ECG ¹ /AC Mains	Color temperature 3000K
DULUX D/E 13 W/830	4058075821934	DULUX LED D/E13 HF & AC MAINS V 6W 830 G24Q-1	ECG ¹ /AC Mains	
DULUX D/E 13 W/840	4058075821958	DULUX LED D/E13 HF & AC MAINS V 6W 840 G24Q-1	ECG ¹ /AC Mains	
DULUX D/E 18 W/827	4058075821972	DULUX LED D/E18 HF & AC MAINS V 7W 830 G24Q-2	ECG ¹ /AC Mains	Color temperature 3000K
DULUX D/E 18 W/830	4058075821972	DULUX LED D/E18 HF & AC MAINS V 7W 830 G24Q-2	ECG ¹ /AC Mains	
DULUX D/E 18 W/840	4058075821996	DULUX LED D/E18 HF & AC MAINS V 7W 840 G24Q-2	ECG ¹ /AC Mains	
DULUX D/E 18 W/865	4058075821996	DULUX LED D/E18 HF & AC MAINS V 7W 840 G24Q-2	ECG ¹ /AC Mains	Color temperature 4000K
DULUX D/E 26 W/827	4058075822016	DULUX LED D/E26 HF & AC MAINS V 10W 830 G24Q-3	ECG ¹ /AC Mains	Color temperature 3000K
DULUX D/E 26 W/830	4058075822016	DULUX LED D/E26 HF & AC MAINS V 10W 830 G24Q-3	ECG ¹ /AC Mains	
DULUX D/E 26 W/840	4058075822030	DULUX LED D/E26 HF & AC MAINS V 10W 840 G24Q-3	ECG ¹ /AC Mains	
DULUX D/E 26 W/865	4058075822030	DULUX LED D/E26 HF & AC MAINS V 10W 840 G24Q-3	ECG ¹ /AC Mains	Color temperature 4000K

Compact fluorescent lamps - DULUX T PLUS, 2 Pins

DULUX LED T EM & AC MAINS V



Conventional lamp	EAN (GTIN)	LED alternative	Ballast	Note to the proposed alternative
DULUX T PLUS 13 W/830	4058075823211	DULUX LED T13 EM & AC MAINS V 6W 830 GX24D-1	CCG/AC mains	
DULUX T PLUS 13 W/840	4058075823235	DULUX LED T13 EM & AC MAINS V 6W 840 GX24D-1	CCG/AC mains	
DULUX T PLUS 18 W/827	4058075823259	DULUX LED T18 EM & AC MAINS V 7W 830 GX24D-2	CCG/AC mains	Color temperature 3000K
DULUX T PLUS 18 W/830	4058075823259	DULUX LED T18 EM & AC MAINS V 7W 830 GX24D-2	CCG/AC mains	
DULUX T PLUS 18 W/840	4058075823273	DULUX LED T18 EM & AC MAINS V 7W 840 GX24D-2	CCG/AC mains	
DULUX T PLUS 26 W/827	4058075823297	DULUX LED T26 EM & AC MAINS V 9W 830 GX24D-3	CCG/AC mains	Color temperature 3000K
DULUX T PLUS 26 W/830	4058075823297	DULUX LED T26 EM & AC MAINS V 9W 830 GX24D-3	CCG/AC mains	
DULUX T PLUS 26 W/840	4058075823310	DULUX LED T26 EM & AC MAINS V 9W 840 GX24D-3	CCG/AC mains	

Compact fluorescent lamps - DULUX T/E PLUS, 4 Pins

DULUX LED T/E HF & AC MAINS V



Conventional lamp	EAN (GTIN)	LED alternative	Ballast	Note to the proposed alternative
DULUX T/E PLUS 13 W/830	4058075822214	DULUX LED T/E13 HF & AC MAINS V 6W 830 GX24Q-1	ECG ¹ /AC Mains	
DULUX T/E PLUS 13 W/840	4058075822238	DULUX LED T/E13 HF & AC MAINS V 6W 840 GX24Q-1	ECG ¹ /AC Mains	
DULUX T/E PLUS 18 W/827	4058075822252	DULUX LED T/E18 HF & AC MAINS V 7W 830 GX24Q-2	ECG ¹ /AC Mains	Color temperature 3000K
DULUX T/E PLUS 18 W/830	4058075822252	DULUX LED T/E18 HF & AC MAINS V 7W 830 GX24Q-2	ECG ¹ /AC Mains	
DULUX T/E PLUS 18 W/840	4058075822276	DULUX LED T/E18 HF & AC MAINS V 7W 840 GX24Q-2	ECG ¹ /AC Mains	
DULUX T/E PLUS 26 W/827	4058075822290	DULUX LED T/E26 HF & AC MAINS V 10W 830 GX24Q-3	ECG ¹ /AC Mains	Color temperature 3000K
DULUX T/E PLUS 26 W/830	4058075822290	DULUX LED T/E26 HF & AC MAINS V 10W 830 GX24Q-3	ECG ¹ /AC Mains	
DULUX T/E PLUS 26 W/840	4058075822313	DULUX LED T/E26 HF & AC MAINS V 10W 840 GX24Q-3	ECG ¹ /AC Mains	
DULUX T/E PLUS 32 W/827	4058075822337	DULUX LED T/E32 HF & AC MAINS V 16W 830 GX24Q-3	ECG ¹ /AC Mains	Color temperature 3000K
DULUX T/E PLUS 32 W/830	4058075822337	DULUX LED T/E32 HF & AC MAINS V 16W 830 GX24Q-3	ECG ¹ /AC Mains	
DULUX T/E PLUS 32 W/840	4058075822351	DULUX LED T/E32 HF & AC MAINS V 16W 840 GX24Q-3	ECG ¹ /AC Mains	
DULUX T/E PLUS 42 W/827	4058075822375	DULUX LED T/E42 HF & AC MAINS V 20W 830 GX24Q-4	ECG ¹ /AC Mains	Color temperature 3000K
DULUX T/E PLUS 42 W/830	4058075822375	DULUX LED T/E42 HF & AC MAINS V 20W 830 GX24Q-4	ECG ¹ /AC Mains	
DULUX T/E PLUS 42 W/840	4058075822399	DULUX LED T/E42 HF & AC MAINS V 20W 840 GX24Q-4	ECG ¹ /AC Mains	

This is just a small selection of LED alternatives from our extensive range of lamps. For more LED alternatives please visit ledvance.com/lampfinder



¹Check ECG compatibility at ledvance.com/compatibility

Light sources affected by the lamp ban	Possible LED alternatives
--	---------------------------

Compact fluorescent lamps – DULUX L



DULUX LED L HF & AC MAINS V



Conventional lamp	EAN (GTIN)	LED alternative	Ballast	Note to the proposed alternative
DULUX L 18 W/827	4058075822054	DULUX LED L18 HF & AC MAINS V 8W 830 2G11	ECG/AC Mains	Color temperature 3 000 K
DULUX L 18 W/830	4058075822054	DULUX LED L18 HF & AC MAINS V 8W 830 2G11	ECG/AC Mains	
DULUX L 18 W/840	4058075822078	DULUX LED L18 HF & AC MAINS V 8W 840 2G11	ECG/AC Mains	
DULUX L 24 W/827	4058075822092	DULUX LED L24 HF & AC MAINS V 12W 830 2G11	ECG/AC Mains	
DULUX L 24 W/830	4058075822092	DULUX LED L24 HF & AC MAINS V 12W 830 2G11	ECG/AC Mains	
DULUX L 24 W/840	4058075822115	DULUX LED L24 HF & AC MAINS V 12W 840 2G11	ECG/AC Mains	
DULUX L 36 W/827	4058075822139	DULUX LED L36 HF & AC MAINS V 18W 830 2G11	ECG/AC Mains	
DULUX L 36 W/830	4058075822139	DULUX LED L36 HF & AC MAINS V 18W 830 2G11	ECG/AC Mains	

Compact fluorescent lamps – DULUX F, 4 Pins



DULUX LED F EM & AC MAINS V



Conventional lamp	EAN (GTIN)	LED alternative	Ballast	Note to the proposed alternative
DULUX F 18 W/830	4058075822412	DULUX LED F18 EM & AC MAINS V 8W 830 2G10	CCG/AC mains	
DULUX F 18 W/840	4058075822436	DULUX LED F18 EM & AC MAINS V 8W 840 2G10	CCG/AC mains	
DULUX F 24 W/827	4058075822450	DULUX LED F24 EM & AC MAINS V 12W 830 2G10	CCG/AC mains	Color temperature 3 000 K
DULUX F 24 W/830	4058075822450	DULUX LED F24 EM & AC MAINS V 12W 830 2G10	CCG/AC mains	
DULUX F 24 W/840	4058075822474	DULUX LED F24 EM & AC MAINS V 12W 840 2G10	CCG/AC mains	
DULUX F 36 W/827	4058075822498	DULUX LED F36 EM & AC MAINS V 20W 830 2G10	CCG/AC mains	Color temperature 3 000 K
DULUX F 36 W/830	4058075822498	DULUX LED F36 EM & AC MAINS V 20W 830 2G10	CCG/AC mains	
DULUX F 36 W/840	4058075822511	DULUX LED F36 EM & AC MAINS V 20W 840 2G10	CCG/AC mains	

¹Check ECG compatibility at ledvance.com/compatibility

This is just a small selection of LED alternatives from our extensive range of lamps. For more LED alternatives please visit ledvance.com/lampfinder



SHEDDING LIGHT AND SYMBOLS

Shatter protection	Output voltage in V	Color temperature in K	Recommended retail price excl. VAT
Type of protection	Luminous flux in lm	Color rendering index	Unit of Packaging
Dimmable	Luminous efficacy	Average period of use/ life in hours (B50/L70)	Fig. no.
Protection Class I	Operating frequency in Hz	Glass Material	Dimming interface DALI-2
Protection Class II	Base	Operation on AC Mains	Push-DIM function
Wireless	Length [mm]	Operation on conventional control gear	LED TUBE EXTERNAL SYSTEM
Power in W for conventional technology	Diameter [mm]	Operation on electronic control gear	SELV voltage
Power in W	Beam angle in °	Energy efficiency class	

Find out more:
[ledvance.com/tubes](https://www.ledvance.com/tubes)

























DAMP PROOF HOUSING

DAMP PROOF HOUSING is an IP65-protected, IK08-rated, economical and – thanks to the replaceable T8 LED tube – sustainable lighting solution. The new generation of this robust luminaire housing is now even better: easier to handle, faster to install and even more versatile in use.

DAMP PROOF HOUSING suitable for LED TUBE T8 EM, LED TUBE T8 EM HIGH TEMPERATURE, LED TUBE T8 EXTERNAL SYSTEM and LED TUBE T8 EM CONNECT.



Product name	EAN (GTIN)	Segmentation			L x W x H [mm] Ø x H [mm]
DAMP PROOF HOUSING GEN 3 – Damp-proof luminaire for T8 LED lamps with tool-free luminaire connector					
DP HOUSING 600 P 1XLAMP IP65	4099854118050	■			675 x 65 x 70
DP HOUSING 600 P 2XLAMP IP65	4099854118074	■			675 x 95 x 70
DP HOUSING 1200 P 1XLAMP IP65	4099854118098	■			1280 x 65 x 70
DP HOUSING 1200 P 2XLAMP IP65	4099854118111	■			1280 x 95 x 70
DP HOUSING 1500 P 1XLAMP IP65	4099854118159	■			1585 x 65 x 70
DP HOUSING 1500 P 2XLAMP IP65	4099854118210	■			1585 x 95 x 70
DAMP PROOF HOUSING DALI – Damp-proof luminaire for dimmable LED TUBE					
DP HOUSING DALI 1200 P 1XLAMP IP65	4099854146442	■			1280 x 65 x 70
DP HOUSING DALI 1200 P 2XLAMP IP65	4099854146466	■			1280 x 95 x 70
DP HOUSING DALI 1500 P 1XLAMP IP65	4099854146480	■			1585 x 65 x 70
DP HOUSING DALI 1500 P 2XLAMP IP65	4099854146503	■			1585 x 95 x 70

A STRONG COMBINATION, E. G. FOR LARGE INDOOR CAR PARKS:



LEDVANCE LED TUBE T8 EM CONNECTED P

LED tube, installed in the robust DAMP PROOF HOUSING (IP65), is connected wirelessly to **LEDVANCE CONNECTED SENSOR ST8 LOW BAY** via Zigbee. Two-stage switching (0% ⇌ 100% and 20% ⇌ 100%) increases efficiency even further.



■ SUPERIOR CLASS ■ PERFORMANCE CLASS ■ VALUE CLASS

* Refer to www.ledvance.com/guarantee for precise conditions
 The pictures shown in the catalog are for illustration purposes only. For information on size and color, please refer to the product table.

ABOUT LEDVANCE



LEDVANCE

With subsidiaries in more than 50 countries and business activities in over 140 countries, LEDVANCE is one of the world's leading companies in the field of general lighting for professional customers and end users. Emerging from OSRAM's general lighting division, LEDVANCE's portfolio includes a wide range of LED luminaires for a variety of applications, intelligent lighting products for smart homes and smart buildings, one of the most comprehensive offerings of advanced LED lamps in the lighting industry, and traditional lamps. Beyond lighting, LEDVANCE offers vertically integrated, renewable energy solutions for the building sector. Together, the lighting division and the renewable energy division form a comprehensive ecosystem for residential, commercial, and industrial buildings. For more information, visit www.ledvance.com.

LEDVANCE GmbH
Parkring 1-5
85748 Garching
Germany
LEDVANCE.COM

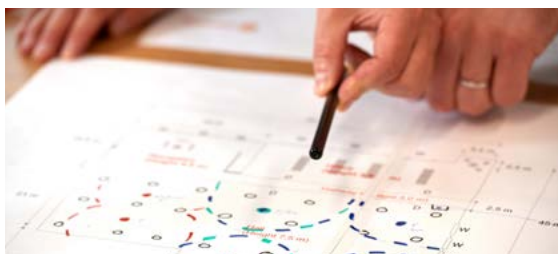

THE ONLINE TRAINING PLATFORM

A host of application-oriented eLearnings for professional users, practical tips concerning installation, integrated standards check, planning tips, and much more.

Register and find out more at training.ledvance.com

Partner:



LEDVANCE.COM