

## PRODUCT DATASHEET

### 2X18...42 DIM

QUICKTRONIC® INTELLIGENT DIM CFL | ECG dimmable 1...10 V for CFL



#### Areas of application

- Suitable for use in emergency lighting systems as per EN 50172/DIN VDE 0108-100
- Industry
- Open-plan offices, corridors and storage rooms
- Public buildings
- Suitable for luminaires of protection class I

#### Product benefits

- Same luminous flux with direct and alternating current
- Perfect lamp start for applications with motion sensors
- Dimming of amalgam lamps without flickering or reduced lifespan
- Very high efficiency thanks to cut-off technology
- Automatic restart after lamp replacement
- ECGs comply with MINERGIE standard due to very low standby consumption
- Configurable emergency power characteristics
- Control via the 1...10 V interface

#### Product features

- Control via 1...10 V interface
- Supply voltage: 220...240 V

- Line frequency: 0 Hz | 50 Hz | 60 Hz
- Line voltage: 198...264 V
- Dimming range: 3...100 % luminous flux
- Lamp start: within 0.6 s
- Lifetime: > 100,000 h (for T = 65 °C at T<sub>0</sub>)
- Automatic shutdown of defective lamps and at end of life (EoL T.2)
- Energy Efficiency Index EEI: A1 BAT
- Overtemperature protection: Thermal management at high t<sub>c</sub> temperatures
- Safety: to EN 61347-2-3
- Lamp operation: to EN 60929
- RI suppression: to EN 55015:2006+A1:2007+A2:2009/CISPR 15
- Line harmonics according to EN 61000-3-2
- Immunity according to EN 61547

TECHNICAL DATA

Electrical data

Nominal wattage	90.00 W
Nominal voltage	220...240 V
Input voltage DC	154...276 V
Type of current	AC/DC
Inrush current	45 A
Mains frequency	50/60 Hz
Max. ECG no. on circuit breaker 10 A (B)	8 <sup>1)</sup>
Max. ECG no. on circuit breaker 16 A (B)	13 <sup>1)</sup>
Operating frequency	42...140 kHz

<sup>1)</sup> Type B

Light technical data

Starting time	0.6 s
---------------	-------

Dimensions & Weight

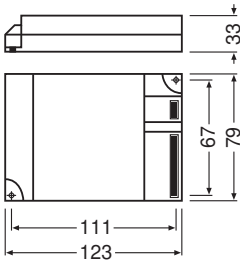

Length	123.00 mm
Mounting hole spacing, length	111,0 mm
Width	79.00 mm
Height	33.00 mm
Wire preparation length, input side	8,5...9,5 mm <sup>1)</sup>
Wire preparation length, output side	8,5...9,5 mm <sup>1)</sup>
Product weight	250.00 g

<sup>1)</sup> Wire cross-section for push-in contacts: 0.5...1.5 mm<sup>2</sup>

## Colors &amp; materials

Casing material	Metal
Body material	Metal

## Temperatures &amp; operating conditions

Ambient temperature range	-10...+50 °C
Maximum temperature at tc test point	75 °C <sup>1)</sup>
Max.housing temperature in case of fault	110 °C
Permitted rel. humidity during operation	5...85 % <sup>2)</sup>

<sup>1)</sup> In case of significant exceeding of max. Tc-point temperature lamp power will be reduced to guarantee ECG lifetime

<sup>2)</sup> Maximum 56 days/year at 85 %

## Lifespan

ECG lifetime	100000 h <sup>1)</sup>
--------------	------------------------

<sup>1)</sup> At T<sub>case</sub> = 65 °C at T<sub>c</sub> point / 10 % failure rate

## Additional product data

Product remark	Optional cable clamp, see chapter ECG mountings - cable clamp
----------------	---

## Capabilities

Dimmable	Yes
Dimming interface	1...10 V
Dimming range	3...100 %
Max. cable length to lamp/LED module	0,5 m
Suitable for fixtures with prot. class	I
End of lamp life safety shutdown	EOL T.2









## Certificates &amp; Standards

Approval marks – approval	VDE / VDE-EMC / EL / EAC / RCM / CCC
Standards	Acc. to EN 55015 / Acc. to EN 61000-3-2 / Acc. to EN 61547
Protection class	1
Type of protection	IP20
Energy efficiency class	A1
EEI – Energy Label	A1 BAT

## LOGISTICAL DATA

Temperature range at storage	-40...+85 °C
------------------------------	--------------

## DOWNLOAD DATA

Documents and certificates	Document name
 User instruction / safety instructions	493509_Technical application guide QUICKTRONIC Intelligent DALI DIM (GB)
 User instruction / safety instructions	597739_EAC QTi T/E DIM
 Declarations of conformity	334957_Declaration of conformity
 Certificates	335097_INOTEC
 Certificates	335169_Manufacturer's declaration – Lamp/ECG combinations: Frequent switching
 Certificates	335125_ENEC/VDE-Marks approval
 Certificates	334953 EMC-Marks approval
 Certificates	504208_VDE-EMC-CERTIFICATE QTi DALI DIM
CAD/BIM files	Document name
 CAD data 3D PDF	321659_QTi-T/E 2x18-42 DIM

## LOGISTICAL DATA

Product code	Packaging unit (Pieces/Unit)	Dimensions (length x width x height)	Gross weight	Volume
4008321060846	Unpacked 1		250.00 g	
4008321060853	Shipping box 20	423 mm x 79 mm x 257 mm	5239.00 g	8.59 dm <sup>3</sup>

The mentioned product code describes the smallest quantity unit which can be ordered. One shipping unit can contain one or more single products. When placing an order, for the quantity please enter single or multiples of a shipping unit.

## DISCLAIMER

Subject to change without notice. Errors and omission excepted. Always make sure to use the most recent release.